

3 – Electronics Cabinet Section

Electronics Assembly - 48-inch

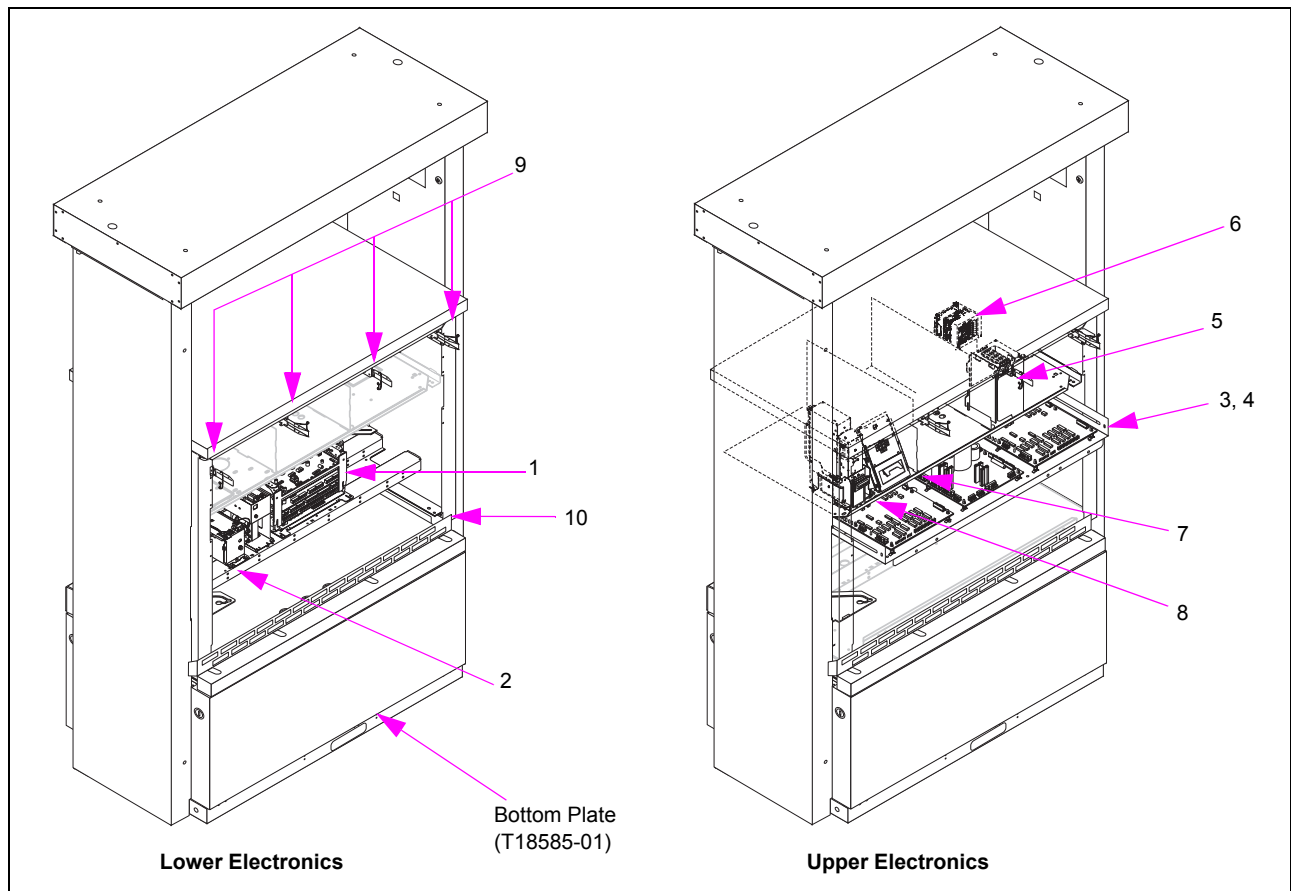

Item #	Part Description	Current Part (Optimized)	Previous Part (Optimized)	Current Part (Modular)	Previous Part (Modular)	Quantity	Refer to
1	Blender Power Supply (no longer used after 4/1/99)	-		-	W02453-G4	1	"Blender Power Supply (W02453-G4)" on page 3-16
2	Main Power Supply Assembly	T19706-G3	T19706-G2	T19706-G1	T16513-G8	1	"Combined Power Supply (T19706-GX)" on page 3-15
3	CRIND Power Supply Logic Tray Assembly (single-line)	W03446-G1		-	-	1	PT-1736
4	CRIND Printer/Cutter Assembly	T20490-GX		-	T17684-GXR	2	PT-1736
5	Cash Acceptor RF	W03095-G2	M03898A001	-	-	2	PT-1736

Item #	Part Description	Current Part (Optimized)	Previous Part (Optimized)	Current Part (Modular)	Previous Part (Modular)	Quantity	Refer to
6	Draw Latch, Toggle with Wire Links: • For Slide in Mount • For Non-slide in Mount (Spare Parts Item)	Q12563-04 Q12563-01		-	-	8	-
7	Bolt Guides	R19439-01		-	-	8	-
8	Weld Nut	Q12516-01		-	-	1	-
9	Retaining Weld Nut Bracket	N23831-01		-	-	1	-
10	Screw	K85736-15		-	-	2	-
Not Shown							
-	Screw, Thread Forming, Hexagonal Washer Head	Q13292-40		-	-	2	-
-	Retainer, Screw	Q10922-02		-	-	2	-

Cabinet Assembly - 48-inch

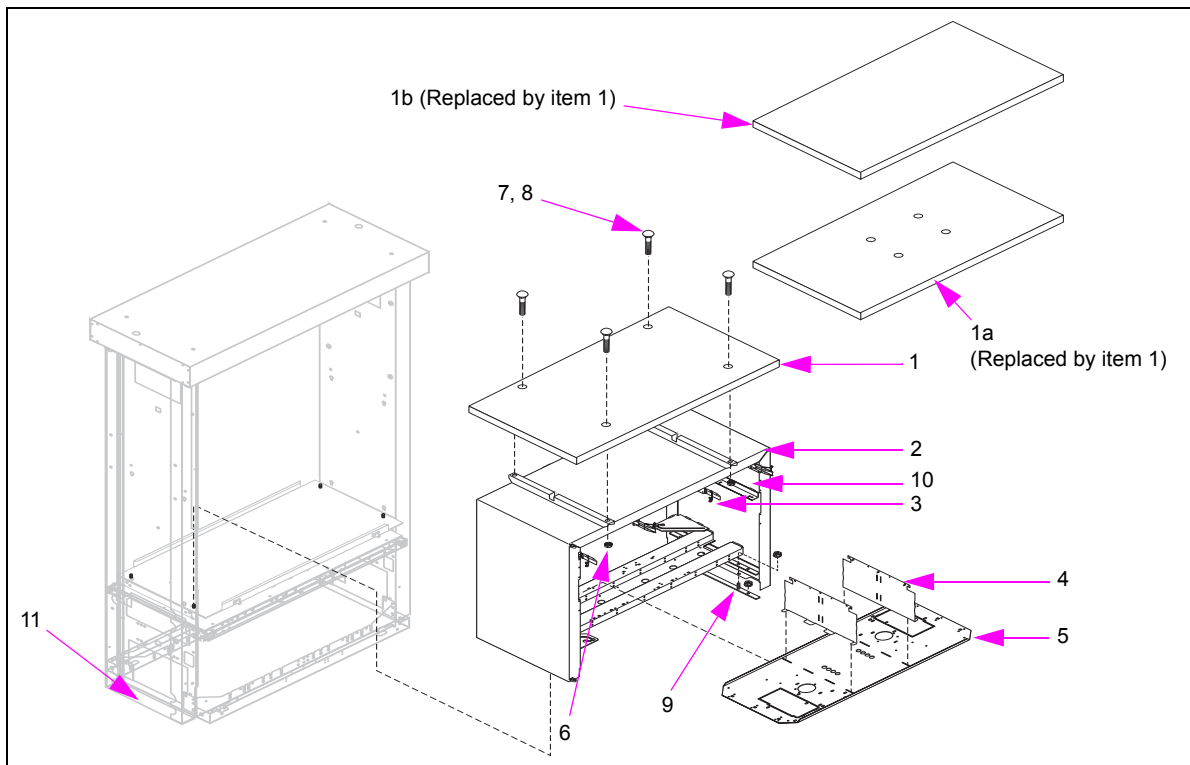

Item #	Part Description	Current Part	Previous Part	Quantity
1	Top Cover Assembly, 48" (order-entry Item) • With Pem Studs • With no Pem Studs	T18600-XX T18600-G1 T18600-01	-	1
1a	Top Cover, 48" (used from 5/93 to 7/96)	-	T18600-XX (see note 1)	1

Item #	Part Description	Current Part	Previous Part	Quantity
1b	Top Cover, 48" (used from 1/91 to 5/93) kit (see note 1) (obsolete, see note 9)	-	T17569-G2	1
-	Top Plate, 48" (used with T17569-G2) (not shown)	-	T17572-G2	1
2	Chassis Kit, 48" frame (see notes 3 and 5)	K96585-01	T17502-G3	1
3	Latch Toggle, Snap-In (rivet base) (see note 4)	-	Q12563-03 Q12563-05	
	Draw Latch [clip base, see note 4 (Spare Parts Item)]	Q12563-04	Q12563-01	8
4	Center Bracket, Black	T17731-04	T17731-G3	2
5	Printer Tray, 48"	K91113-01	T18700-G3	1
6	Nut, Hexagonal, Flange Serrated, #10-24	Q11890-07	-	4
7	Bolt, Black #10-24 X 3/4" (see note 6)	K02394-50	-	4
8	Bolt, Stainless Steel #10-24 X 3/4" (see note 6)	K02394-51	-	4
9	Mounting Bracket, Lower	T20421-G1	-	1
10	Mounting Bracket, Upper	T20422-01	-	1
11	Base, Cosmetic Cover	T18585-01**XX (see note 7)	-	1
Not Shown				
-	Top Cover Bracket Kit	K96605-01	-	1
<p>Notes:</p> <ol style="list-style-type: none"> Quantities per unit. T17729-G2 was built from 01/91 to 05/93. T18599-G1 was built from 05/93 to 7/96. Current and previous parts cannot replace each other. T17732-G3 was used on units built before 4/20/98. T20114-GX was used on units built after 4/20/98. To install new T20114 on units built before 4/20/98, order K96585-02 Kit. Draw Latch Clips (Q12563-04) on unit while Latch (Q12563-01) is attached using bolts #10-32. The bracket configures one required for older units before 12/22/98 to adapt the hole configuration on the current chassis. Customer to use black or stainless steel bolts as required for specific Top Cover unit. **XX indicates color is required. All parts may not be available as spare parts. No replacement. 				

Electronics Assembly - 36-inch

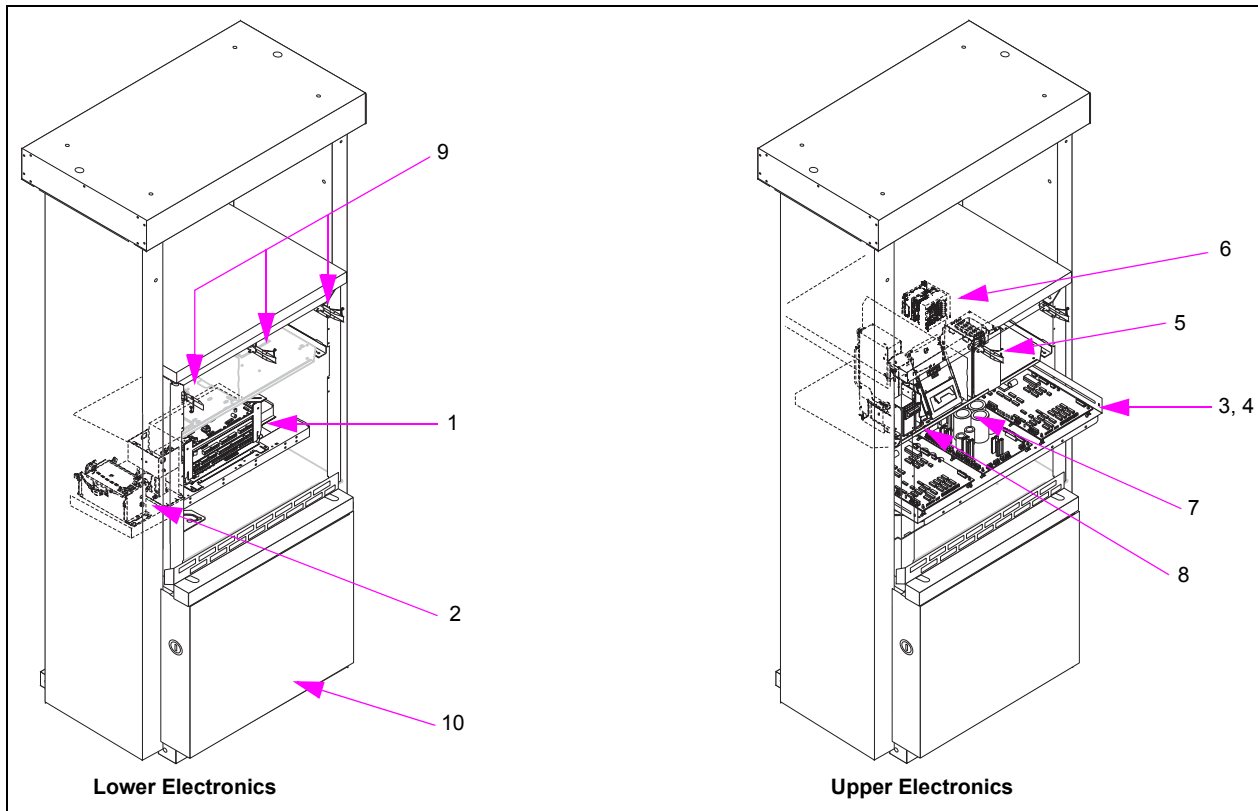

Item #	Part Description	Current Part (Optimized)	Previous Part (Optimized)	Current Part (Modular)	Previous Part (Modular)	Quantity	Refer to
1	Main Power Supply Assembly	T19706-G3	T19706-G2	T19706-G1	T16513-G8	1	"Combined Power Supply (T19706-GX)" on page 3-15
2	CRIND Printer/Cutter Assembly	T20490-GX		-	T17684-GXR	2	PT-1736
3	Draw Latch, Toggle with Wire Links	Q12563-04		-	-	6	-
4	Base, Cosmetic Cover	T18585-01**XX (see note 1)		-	-	1	-
Not Shown							
-	Blender Power Supply (no longer used after 4/1/99)	-		-	W02453-G4	1	"Blender Power Supply (W02453-G4)" on page 3-16
-	Logic Tray Assemblies	-		-	-	-	-
Notes: 1. **XX indicates color is required. 2. All parts may not be available as spare parts.							

Cabinet Assembly - 36-inch

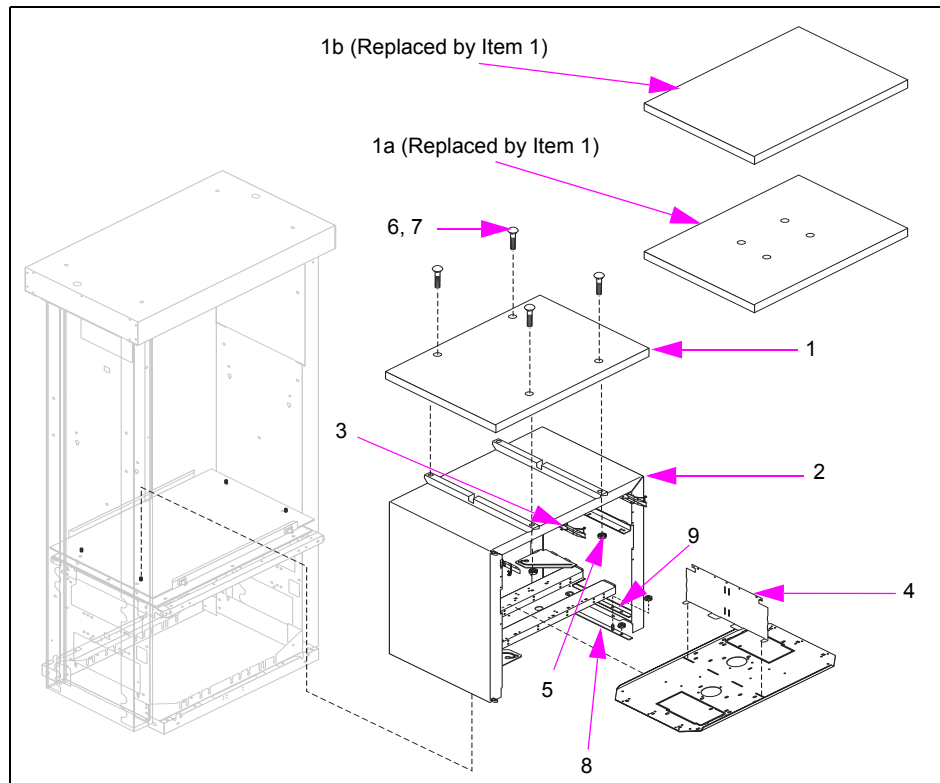

Item #	Part Description	Current Part	Previous Part	Quantity
1	Top Cover, 36" (order-entry Item), Color Coded	T18599-01**XX (see note 7)	-	1
1a	Top Cover, 36", Black (see note 1), Color Coded	-	T18599-XX (see note 6)	1
1b	Top Cover Assembly, 36", Black (see note 1), Color Coded	-	T17729-G2	1
2	Chassis Kit, 36" Frame (see notes 2 and 4)	K96585-02	T17732-G3	1
3	Draw Latch [clip base, see note 3 (Spare Parts Item)]	Q12563-04	Q12563-01	6
4	Center Bracket, Black	T17731-04	T17731-G3	1
5	Nut, Hexagonal, Flange Serrated, #10-24 (see note 5)	Q11890-07	-	4
6	Bolt, Black #10-24 X 3/4" (see note 5)	K02394-50	-	2
7	Bolt, Stainless Steel #10-24 X 3/4"	K02394-51	-	2
8	Mounting Bracket, Lower	T20421-G1	-	1
9	Mounting Bracket, Upper	T20422-01	-	1

Not Shown

-	Top Plate Assembly, 36" [used with T17729-G2 (see note 1)]	-	T17728-G2	1
---	--	---	-----------	---

Notes:

- Quantities per unit.
- T17729-G2 was built from 01/91 to 05/93. T18599-G1 was built from 05/93 to 7/96. Current and previous parts cannot replace each other.
- T17732-G3 was used on units built before 4/20/98. T20114-GX was used on units built after 4/20/98. To install new T20114 on units built before 4/20/98, order K96585-02 Kit.
- Draw Latch Clips (Q12563-04) on unit while Latch (Q12563-01) is attached using bolts #10-32.
- The bracket configures one required for older units before 12/22/98 to adapt the hole configuration on the current chassis.
- Customer to use black or stainless steel bolts as required for specific Top Cover unit.
- **XX indicates color is required.
- All parts may not be available as spare parts.

Modular Card Cage Assembly (Metal Type)

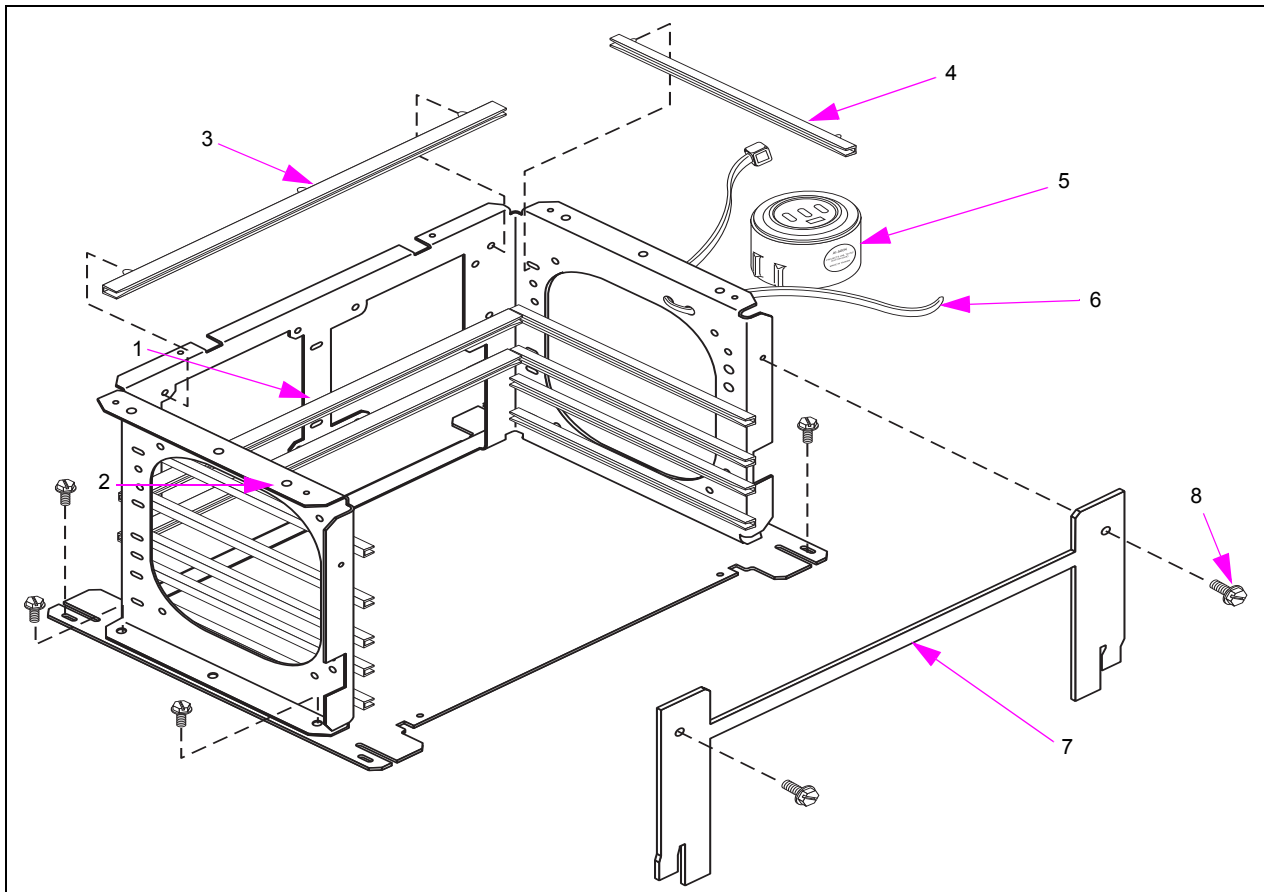

Item #	Part Description	Current Part	Previous Part	Quantity
1	Card Cage (used from 1/90 through 3/99) (see note 1)	T17288-G3	-	1
2	Screw, Hexagonal-head, Unslotted, #10-32 X 1/2"	K85736-15	-	4
3	Snap-in Card Guide, 8"	Q10233-06	-	3
4	Snap-in Card Guide, 6"	Q10233-05	-	10
5	Transducer, Audio (see note 2)	Q11763-01	-	1
6	Cable-tie (see note 2)	Q10178-07	-	1
7	Retainer Bracket	T19073-01	T19073-G1	1
8	Screw, #6-20 X 3/8"	Q11677-24	-	2

Notes:

1. T20361-G1 (plastic) is a direct replacement for T17288-G3 except for units using VaporVac system.
2. Cable-tie and Transducers are not on Card Cage Assemblies (PGT18914-G37, -G39, -G41, -G43, -G44, and -G45).
3. All parts may not be available as spare parts.

Modular Card Cage Assembly (Plastic Type)

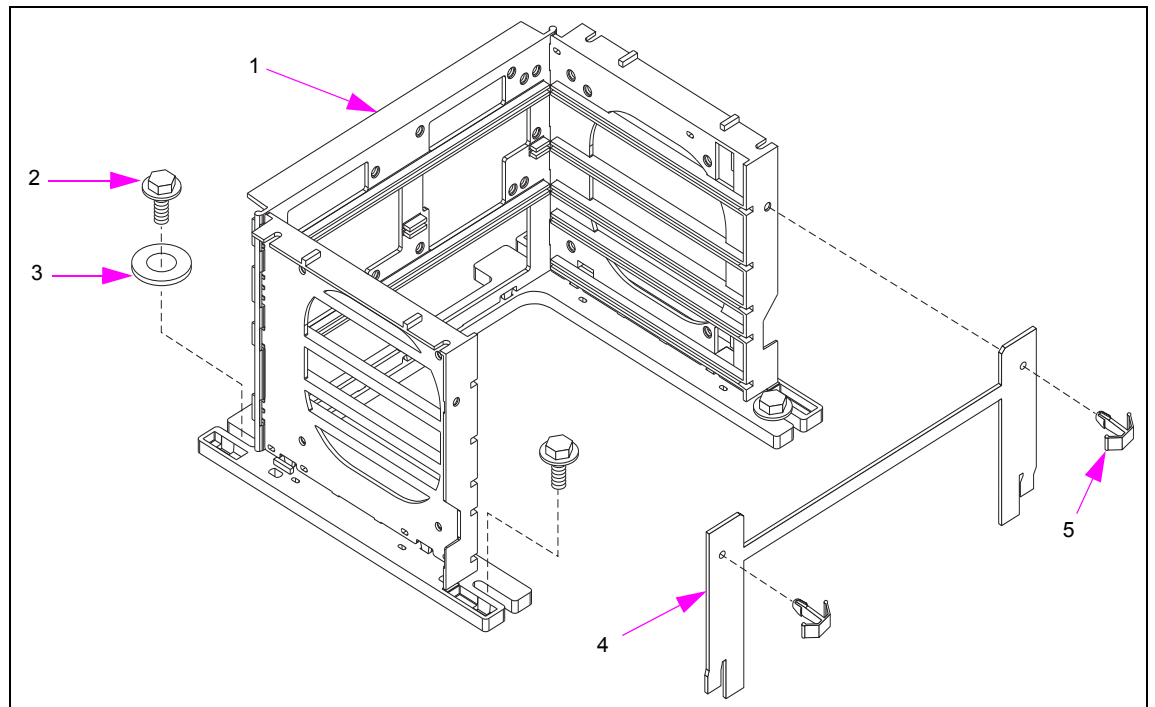

Item #	Part Description	Current Part	Previous Part	Quantity	G Level PGT18914-GXX
1	Plastic Card Cage	T20361-G1	-	1	G1 through G45
2	Bolt and Washer Combination	Q13702-01	-	4	G1 through G45
3	Washer, Nylon	K83513-13	-	1	G1 through G45
4	Front Bracket	T20361-05	-	1	G1 through G45
5	Stand-off	Q13701-01	-	2	G1 through G45

Modular Card Cage PCBs

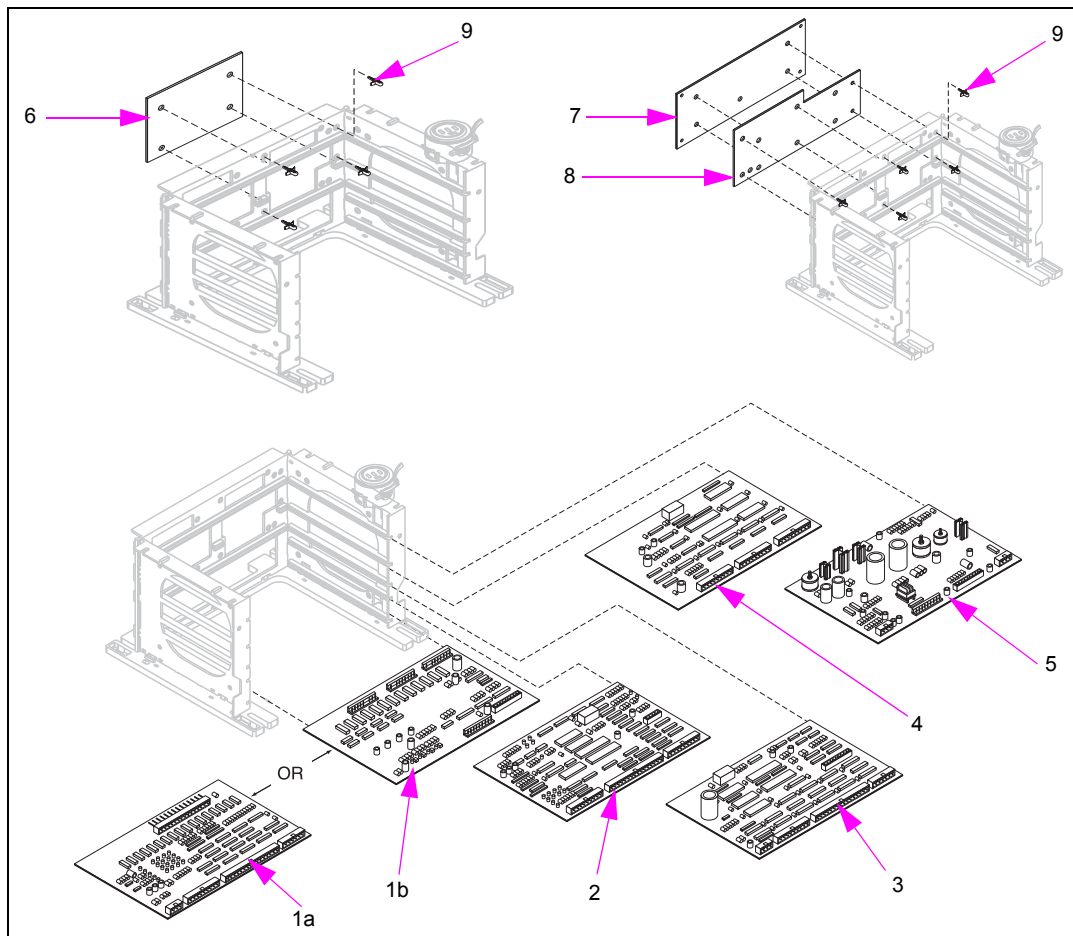

Item #	Part Description	Current Part	Previous Part	Quantity	G Level
1a	Hydraulic Interface Board (MPDs)	T18024-G2	-	1	G1, G5, G6, G10, G33, G34, G35, G36
1b	Valve Driver Board (blenders)	T17461-G2	-	1	G3, G8
2	Hydraulic Interface Board (blenders)	T18156-G1	-	1	G3, G8
3	Pump Controller Board (see note 3)	T20005-G4	T18202-G4	1	G1, G3, G5, G6, G8, G10
4	PPP Board (see notes 3 and 5)	T17331-G3	-	1	G6, G8, G10
5	Main Regulator Board	T17723-G1	T17723-G2	1	G1, G3, G5, G6, G8, G10, G33, G34, G35, G36
6	Grade Select Board (1 to 3-grades) (see note 8)	T19756-G1	-	1	G5, G10, G15, G20, G23, G26, G29, G32, G35, G36

Item #	Part Description	Current Part	Previous Part	Quantity	G Level
7	Grade Select Board (4-grades)	T19800-G1	-	1	G5, G10, G35, G36
8	Submersible Turbine Pump (STP) Driver Bracket	R19776-02	-	1	G5, G10, G35, G36
9	Circuit Board Support, 1/4" (see note 7)	Q10651-02	-	1	G5, G10, G35, G36, G39, G41, G44, G45

Notes:

1. Card Cage Assembly (PGT18914-GXX) includes Items 1 through 10. G Level column lists specific dash numbers for each Card Cage Assembly. For additional parts, refer to "Modular Card Cage Assembly (Plastic Type)" on page 3-7.
2. For latest board configurations, refer to "Modular Card Cage Board Configurations" on page 3-10.
3. Use T17331-G4 and T18202-G5 for European models. T18202-G5 has been replaced by T20005-G5, Item 10.
4. T17723-G2 used for new units.
5. This position is used for T19501-G1 board when monochrome is used.
6. T20005-G5 is non-illustrated. CE European use only.
7. Circuit Board Support is used for both modular and optimized units. Quantities will vary between the two units. Use quantity of 8 on circuit boards -G5, -G10, -G35, -G36; use quantity of 4 on circuit boards -G39, -G41, -G44, -G45.
8. Grade Select Board (T19756-G1) used only with modular units.
9. All parts may not be available as spare parts.

Optimized Electronics Card Cage PCBs

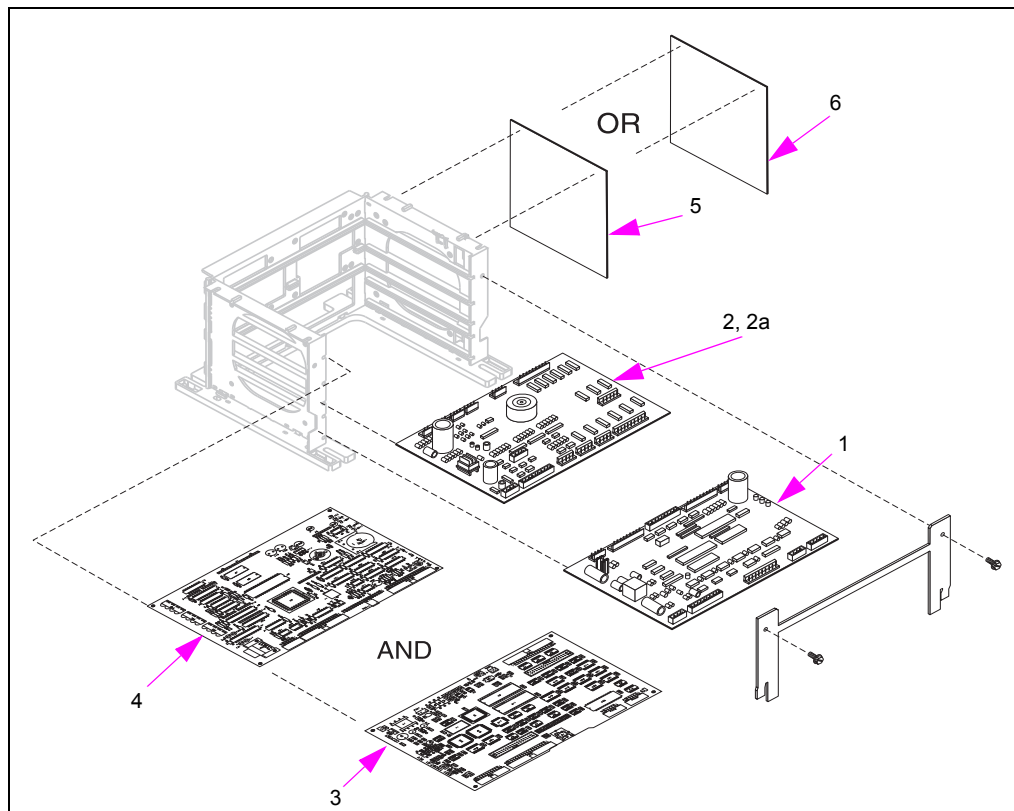

Item #	Part Description	Current Part	Previous Part	Quantity	Card Cage Assembly PGT18914-GXX (obsolete, see note 5)
1	Pump Interface Assembly	T20076-G3	T20076-G1	1	G37, G39, G41, G43, G44, G45
2	Pump Controller Board (see note 2)	T20011-G1	-	1	G37, G39, G41
2a	Pump Controller Board (see note 2)	T20011-G2	-	1	G43, G44, G45
3	Optimum Automatic Temperature Compensation (ATC) Control, Printed Circuit Assembly (PCA) (Canada only) (see note 3)	T20569-G1	-	1	G44
4	Optimum Monochrome CPU (see note 3)	T19501-G2	T19501-G1	1	(see note 3)
5	Optimum Relay PCB (see note 4)	T20284-G1	-	1	G41, G45
6	Optimum Grade Select PCB	T20275-G1	-	1	G39, G44
Not Shown					
-	Plastic Card Cage Assembly (see note 1)	T20361-G1	-	1	G1 through G45
Notes:					
1. For latest board configurations, refer to "Optimized Card Cage Board Configurations" on page 3-11.					
2. T20287-G1 and T19501-G2 are optional boards.					
3. T20284-G1 is used with six-hose Blender.					
4. All parts may not be available as spare parts.					
5. No replacement.					

Modular Card Cage Board Configurations

Unit Description (see note 1)	PPP	ATC	Hose Outlet	Use Board Item # (see note 2)	Part Number (PGT18914-GXX) (MFG only) (obsolete, see note 5)	Replaced P/N (see note 3)
Blenders						
36" SB, 48" SB or FB	-	-	Other	1b, 2, 3, 5	-G3	-
36" SB, 48" SB or FB	Yes	-	Other	1b, 2, 3, 4, 5	-G8	-
36" SB, 48" SB or FB	-	-	VaporVac	1b, 2, 3, 5	-G13	replaced by -G3
36" SB, 48" SB or FB	Yes	-	VaporVac	1b, 2, 3, 4, 5	-G18	replaced by -G8
36" SB, 48" SB or FB	-	Yes	Other	1b, 2, 3, 5	-G22	replaced by -G3
36" SB, 48" SB or FB	Yes	Yes	Other	1b, 2, 3, 4, 5	-G25	replaced by -G8
36" SB, 48" SB or FB	-	Yes	VaporVac	1b, 2, 3, 5	-G28	replaced by -G3
36" SB, 48" SB or FB	Yes	Yes	VaporVac	1b, 2, 3, 4, 5	-G31	replaced by -G8
Non-Blenders						
36", 48" Dispenser or Pump, 1-3 grades	-	-	Other	1a, 3, 5	-G1	-
48" Dispenser, 4-grades	-	-	Other	1a, 3, 5, 6, 7, 9	-G5	-
36", 48" Dispenser or Pump, 1-3 grades	Yes	-	Other	1a, 3, 4, 5	-G6	-
48" Dispenser, 4-grades	Yes	-	Other	1a, 3, 4, 5, 6, 7, 9	-G10	-
36", 48" Dispenser or Pump, 1-3 grades	-	-	VaporVac	1a, 3, 5	-G11	replaced by -G1
48" Dispenser, 4-grades	-	-	VaporVac	1a, 3, 5, 6, 7, 9	-G15	replaced by -G5
36", 48" Dispenser or Pump, 1-3 grades	Yes	-	VaporVac	1a, 3, 4, 5	-G16	replaced by -G6
48" Dispenser, 4-grades	Yes	-	VaporVac	1a, 3, 4, 5, 6, 7, 9	-G20	replaced by -G10
36", 48" Dispenser or Pump, 1-3 grades	-	Yes	Other	1a, 3, 5	-G21	replaced by -G1
48" Dispenser, 4-grades	-	Yes	Other	1a, 3, 5, 6, 7, 9	-G23	replaced by -G5

Unit Description (see note 1)	PPP	ATC	Hose Outlet	Use Board Item # (see note 2)	Part Number (PGT18914-GXX) (MFG only) (obsolete, see note 5)	Replaced P/N (see note 3)
36", 48" Dispenser or Pump, 1-3 grades	Yes	Yes	Other	1a, 3, 4, 5	-G24	replaced by -G6
48" Dispenser, 4-grades	Yes	Yes	Other	1a, 3, 4, 5, 6, 7, 9	-G26	replaced by -G10
36", 48" Dispenser or Pump, 1-3 grades	-	Yes	VaporVac	1a, 3, 5	-G27	replaced by -G1
48" Dispenser, 4-grades	-	Yes	VaporVac	1a, 3, 5, 6, 7, 9	-G29	replaced by -G5
36", 48" Dispenser or Pump, 1-3 grades	Yes	Yes	VaporVac	1a, 3, 4, 5	-G30	replaced by -G6
48" Dispenser, 4-grades	Yes	Yes	VaporVac	1a, 3, 4, 5, 6, 7, 9	-G32	replaced by -G10
36", 48" Dispenser or Pump, 1-3 grades (European) (obsolete, see note 5)	-	-	Other	1a, 5, 10	-G33	-
36", 48" Dispenser or Pump, 1-3 grades (European) (obsolete, see note 5)	Yes	-	Other	1a, 5, 10	-G34	-
48" Dispenser, 4-grades (European) (obsolete, see note 5)	-	-	Other	1a, 5, 6, 7, 9, 10	-G35	-
48" Dispenser, 4-grades (European) (obsolete, see note 5)	Yes	-	Other	1a, 5, 6, 7, 9, 10	-G36	-

Notes:
1. *FB = Fixed Blender. SB = Selectable Blender.*
2. *For board definitions and part number, refer to "Modular Card Cage Board Configurations" on page 3-10.*
3. *This column shows a list of all part numbers (P/N) that are replaced with another dash (-) number.*
4. *All parts may not be available as spare parts.*
5. *No replacement.*

Optimized Card Cage Board Configurations

Unit Description	PPP	ATC	Hose Outlet	Use Board item # (see note 1)	Part Number (PGT18914-GXX) (MFG only) (obsolete, see note 3)
Blenders					
Advantage with Optimized Electronics X + 1, 4 + X, 5 + X (obsolete, see note 3)	Yes	-	-	1, 2, 6, 9	-G39
Advantage with Optimized Electronics Six-hose (obsolete, see note 3)	Yes	-	-	1, 2, 5, 9	-G41
Advantage with Optimized Electronics X + 1, 4 + X, 5 + X (CE European) (obsolete, see note 3)	Yes	-	-	1, 2a, 6, 9	-G44
Advantage with Optimized Electronics Six-hose (CE European) (obsolete, see note 3)	Yes	-	-	1, 2a, 5, 9	-G45
Non-Blenders					
Advantage with Optimized Electronics 3-grades (obsolete, see note 3)	Yes	-	-	1, 2	-G37
Advantage with Optimized Electronics 3-grades (CE European) (obsolete, see note 3)	Yes	-	-	1, 2	-G43

Notes:
1. *For board definitions and part numbers, refer to "Optimized Card Cage Board Configurations" on page 3-11.*
2. *All parts may not be available as spare parts.*
3. *No replacement.*

Main Power Supply Distribution

For this Period	The Advantage model	Requires This Power Supply	G Level	Has These Features	Interchangeable With
Before 7/97	Modular	T16513*	-G6	Supplies backlight power and has battery	None
	Modular and 4 X 4	K94441-01	-G8	Uses IDC connectors and does not use battery	K94441-01 except 4 X 4
8/97-7/98	All, except 4 X 4 and Optimized Electronics	T19706	-G1	<ul style="list-style-type: none"> Combine CRIND and main power supplies. Direct replacement for T16513-G8 with K94441-01 Kit. Not interchangeable with -G3. 60 V 	None
4/1/99	With Optimized Electronics		-G3	<ul style="list-style-type: none"> Combine CRIND and main power supplies. Not interchangeable with -G1. 24 V 	None
-	4 X 4			Direct replacement for T16513-G8 with K94434-01 Kit. (obsolete, see note 3)	-
7/97	4 X 4 and Optimum	T19868	-G1	Combined power supply replaces T16513-G8	None

Notes:
 1. *Q11955-01 Battery is replaceable for T16513-G5 and -G6. (T16513-G5 is obsolete and no replacement.)
 2. All parts may not be available as spare parts.
 3. K94434-01 is obsolete and no replacement.

Main Power Supply (T16513-G6)

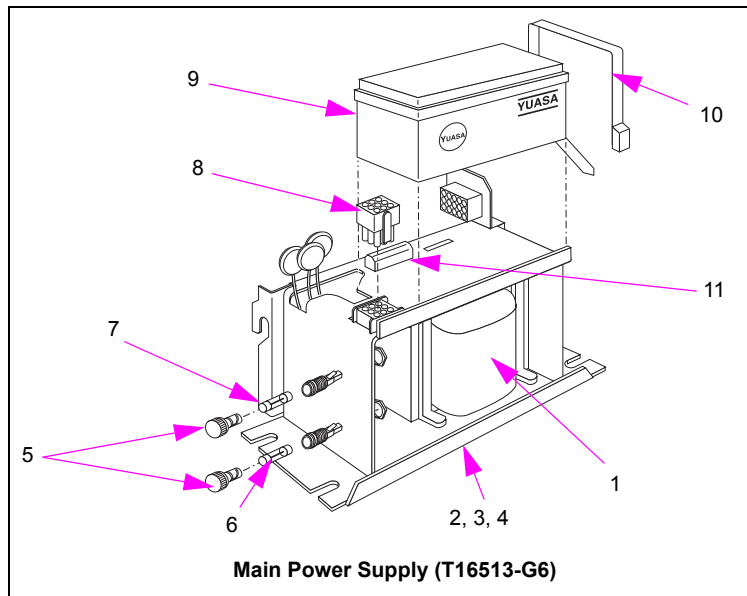

Item #	Part Description	T16513-G6	T16513-G5 (obsolete, see note 4)	Quantity
1	Transformer Subassembly	Q12939-02	Q12190-01	1
2	Power Supply Bracket, Top	T17478-G2	-	1
3	Power Supply Bracket, End	T17479-G2	-	1
4	Power Supply Bracket, Base	T17477-G2	-	1
5	Fuse Holder Assemblies	Q11781-01	-	2
6	Fuse, 3 A, 250 V	Q10131-03	-	1
7	Fuse, 4 A, 250 V	Q10131-26	-	1
8	Variable Voltage Plug (order-entry Item)	N21120-GXX	-	1
9	Battery, Lead Acid 2.5 AH	Q11955-01	-	1
10	Cable-tie	Q10178-06	-	1
11	Resistor	K89231-07	-	1
Not Shown				
-	Fuse Decal	R16795-34	R16795-31	1
-	Main Power Supply Assembly (see note 1)			
	• 09/93 to 10/95	-G6	-	-
	• Before 09/93	-	-G5	-
Notes: 1. Quantities per main power supply. 2. Assembly includes Items 1 through 13. 3. All parts may not be available as spare parts. 4. T16513-G5 is obsolete and no replacement.				

Main Power Supply (K94441-01)

Note: Replaced by "Main Power Supply Distribution (T19706-G1)" in 08/97. Refer to "Combined Power Supply (T19706-GX)" on page 3-15.

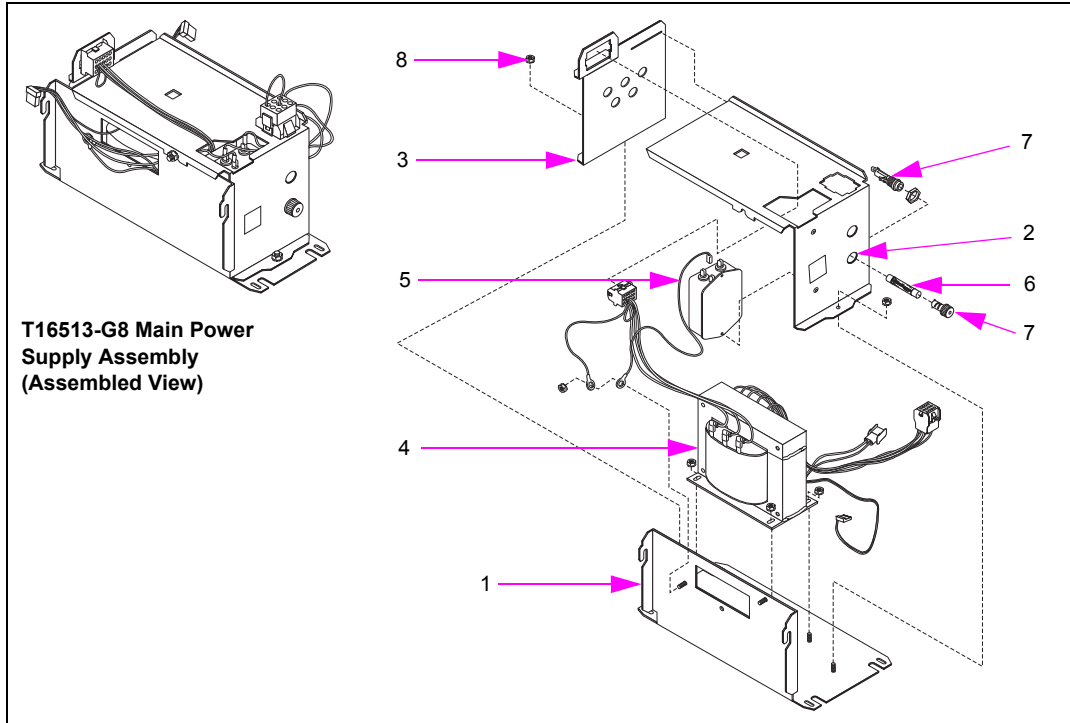

Item #	Part Description	Current Part	Previous Part	Quantity
Not Shown				
-	Main Power Supply Assembly			
	• 10/95 to 08/97 (see notes 1 and 2)	K94441-01	-	1
Notes: 1. Quantities per main power supply. 2. Main Power Supply Assembly includes Items 1 through 8. 3. All parts may not be available as spare parts.				

Combined Power Supply (T19706-GX)

Note: Released in 08/97. Replaces "Main Power Supply (K94441-01)".

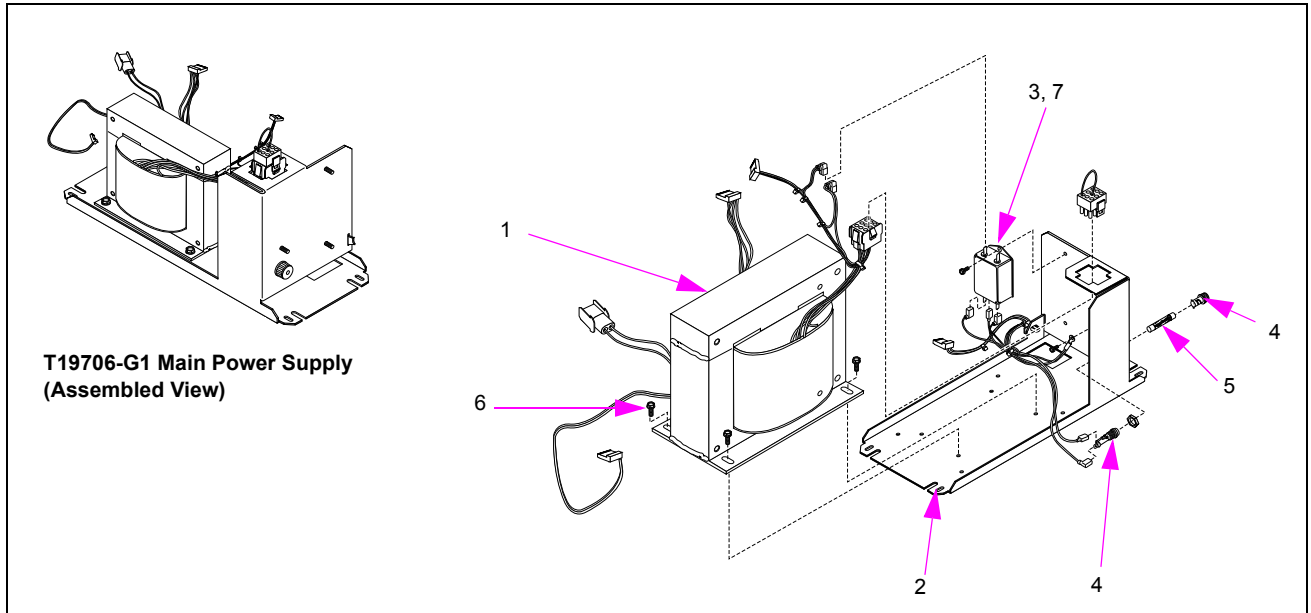

Item #	Part Description	Current Part	Previous Part	Quantity
1	Transformer Subassembly	T19706-G1	-	1
2	Power Supply Base Bracket (see note 5)	T19696-01	-	1
3	Filter	Q10895-07	-	1
4	Fuse Holder Assembly	Q11781-01	-	1
5	Fuse, 5 A, 250 V	Q10131-04	-	1
6	Screw, #10-32 X 1/4"	K85736-14	-	4
7	Screw, #8-32 X 1/4" (obsolete, see note 7)	-	K85736-13	3

Not Shown				
-	Fuse Decal	R16795-45	-	1
-	Combined Power Supply Assembly (see note 1)	-	-	-
	• 4/99 to Present (see note 3)	T19706-G3	T19706-G2	1
	• 08/97 to Present (see note 2) – part of K94441-01	T19706-G1	T16513-G8	1

Notes:

- Quantities per combined power supply.
- Combined Power Supply assembly includes Items 1 through 8. Replaces Main Power Supply Assembly (T16513-G8).
- Power Supply (T19706-G1) built after 7/97. Used on all Advantage models except 4 X 4 and Optimized Electronic units.
- Power Supply (T19706-G2) built after 8/98; replaced by T19706-G3 beginning in 2/00. Used on 4 X 4 and Optimized Electronic units.
- Power Supply Base Bracket (T19696-01) is not sold individually. It is sold as a part of T19706-G1.
- All parts may not be available as spare parts.
- No replacement.

Blender Power Supply (W02453-G4)

Note: Replaces “Blender Power Supply (W02453-G2)”.

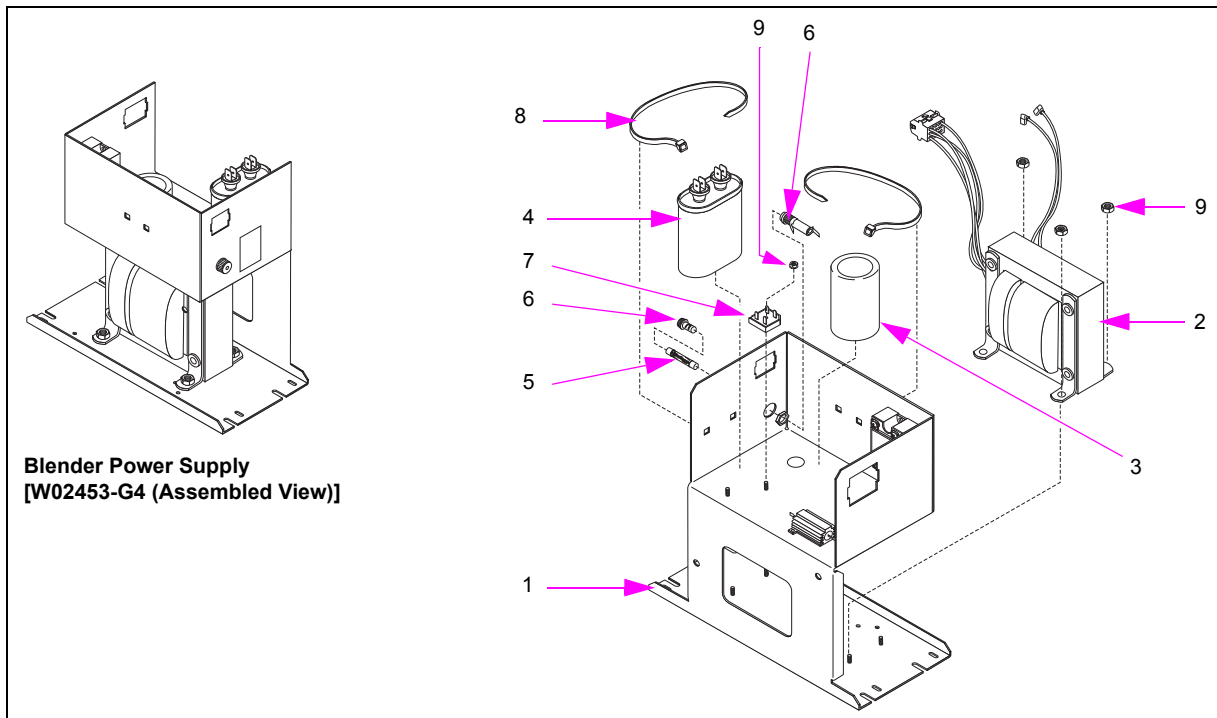

**Blender Power Supply
[W02453-G4 (Assembled View)]**

Item #	Part Description	Current Part	Previous Part	Quantity
1	Power Supply Chassis	W03459-G2	-	1
	Decal, Fuse	R16795-25	-	1
2	Valve Driver Assembly	R18988-G1	-	1
3	Capacitor, 2100 MF, 75 VDC	Q10271-31	-	1
4	Capacitor, 2 MF, 600 VAC	Q12018-01	-	1
5	Time-delay Fuse, 4 A, 250 VAC	Q10131-37	-	1
6	Fuse Holder	Q11781-01	-	2
7	Bridge Rectifier	Q10459-03	-	1
8	Cable-tie	Q10178-05	-	2
9	Nut, Hexagonal, #8-32	Q12068-03	-	6
Not Shown				
-	Blender Power Supply Assembly (see note 1)			
-	• Units Manufactured Before 4/99 (see notes 2 and 3)	W02453-G4	W02453-G2	1
Notes: 1. Assembly includes Items 1 through 9. Used in Advantage Series blenders. 2. For units built after 4/99 with Optimized Electronics, refer to T19706-G3, “Combined Power Supply (T19706-GX)” on page 3-15. 3. Power Supply (W02453-G2) is inactive since 1995. 4. All parts may not be available as spare parts.				