

Section Ten

Dials

Page
Number

<i>Dial Latch Assembly</i>	10-2
<i>Dial Adapter Kit</i> For 3 Piece Dial (mounted to steel enclosure)	10-3
<i>Dial Assembly</i>	
<u>Three Piece</u>	
Front Lit; Model 300, 400 & 600 Series (non-A)	
Dial Assembly	10-4
Price Per Gallon Panel Assembly	10-5
Money/Volume Panel Assembly	
Serial No. 108-15757 & Below	10-6, 10-7
Serial No. 108-15758 & Above	10-8, 10-9, 10-10
Back Lit; Model 300A, 400A & 600A Series (TCSA)	
Dial Assembly (Three Piece)	10-11
Price Per Gallon Panel Assembly	10-12, 10-13
Money/Volume Panel Assembly	10-14, 10-15, 10-16
<u>One Piece</u>	
TCS "A" Speaker & Presets Assembly	10-17
TCS High Cash/Credit Button Assembly	10-18, 10-19
TCS Low Cash/Credit Button Assembly	10-20, 10-21
TCS "A" Money Volume/Dial Assembly; Back Lit	10-22, 10-23
<u>Mobil One Piece</u>	
TCS Mobil; Money/Volume	10-38, 10-39
TCS Mobil; Cash/Credit/Presets & Speaker	10-40, 10-341
<u>DPT</u>	
Dial Assembly for 45" & 60" DPT	10-24, 10-25
<u>Model 322A-B3/B5 Product Variable Blender - One Piece</u>	
Model 322A-B3/B5 One Piece Dial Assembly	10-26, 10-27, 10-28
<u>Model 411A & 422A - One Piece</u>	
Speaker & Presets Assembly	10-29
Dial Assembly, Back Lit	10-30, 10-31
<u>Wiring Schematic</u>	
For 30" 3 & 5 Product Dial	10-32, 10-33
For TCS "A" Mobil Product Dial	10-36, 10-37
<u>Speaker & Call Button Wiring</u>	10-34
<u>One Piece Dial Blank Assembly</u>	10-35

T
C
S
A

D
I
S
P
E
N
S
E
R

DIAL LATCH ASSEMBLY

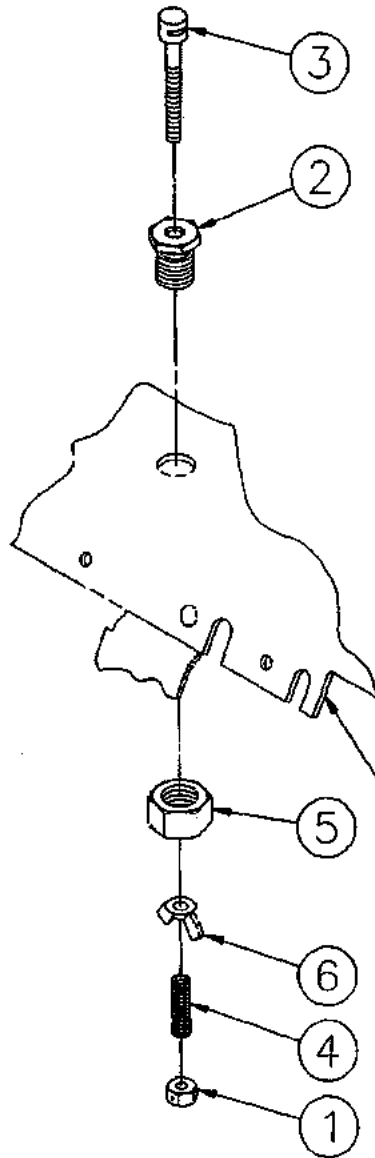

(Ref.) Barrier plate weld assembly
called out on CHASSIS ASSEMBLY
see dwg. no. 741277 & 741328

Item No.	Part No.	Part Name
1	1-131576	Two-way Lock Nut
2	1-228626	Bushing
3	1-228627	Pin
4	3-317420	Spring
5	05-50301	1/2-13 Hex Nut
6	06-50381	#10-32 Wingnut

DIAL ADAPTER KIT

(FOR THREE PIECE DIAL MOUNTED TO STEEL ENCLOSURE)

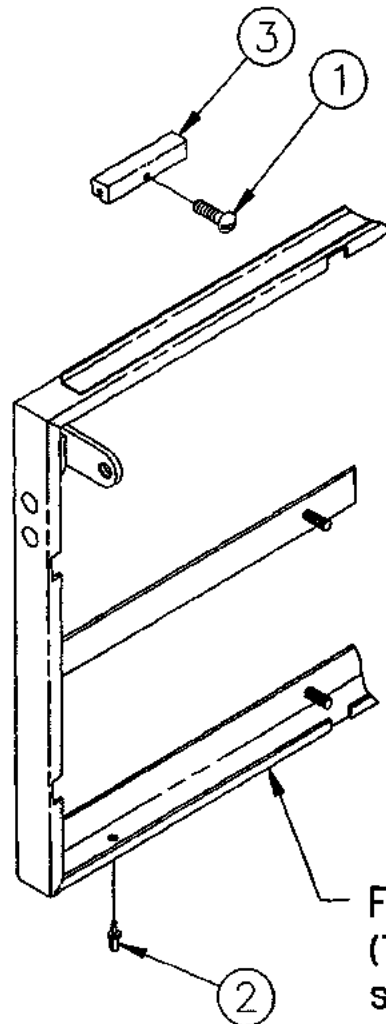

Item No.	Part No.	Name Of Part
1	1-132448	#6-32 Rd. Hd. Thrd. Cutting Screw
2	1-229652	Plastic Rivet
3	1-230888	Dial Adapter

For parts callout of
 (THREE PIECE) DIAL ASSY.
 see dwg. no. 741284
 or 741313

1-72208

FRONT LIT DIAL ASSEMBLY (THREE PIECE)

MODEL 300, 400 & 600 SERIES

Item No.	Part No.	Name Of Part
1	1-126616	Washer
2	1-131006	Pop Rivet
3	1-131571	Sealing Strip
4	1-228640	Bracket
5	1-228641	Link
6	1-231143	Pin
7	1-228675	Sealing Strip
8	418130-1	Dial Frame Weld Assy. (30")
	418130-2	Dial Frame Weld Assy. (30" Blank)
	418132-1	Dial Frame Weld Assy. (45")
	418132-2	Dial Frame Weld Assy. (45" Blank)
	418134-1	Dial Frame Weld Assy. (60")
	418134-2	Dial Frame Weld Assy. (60" Blank)
9	1-418535	Sealing Strip (60")
	1-418536	Sealing Strip (45")
	1-418537	Sealing Strip (30")
10	05-50211	#10-24 Hex Nut
11	06-52482	Truarc "E" Retaining Ring
12	05-50621	#10 Plain Washer

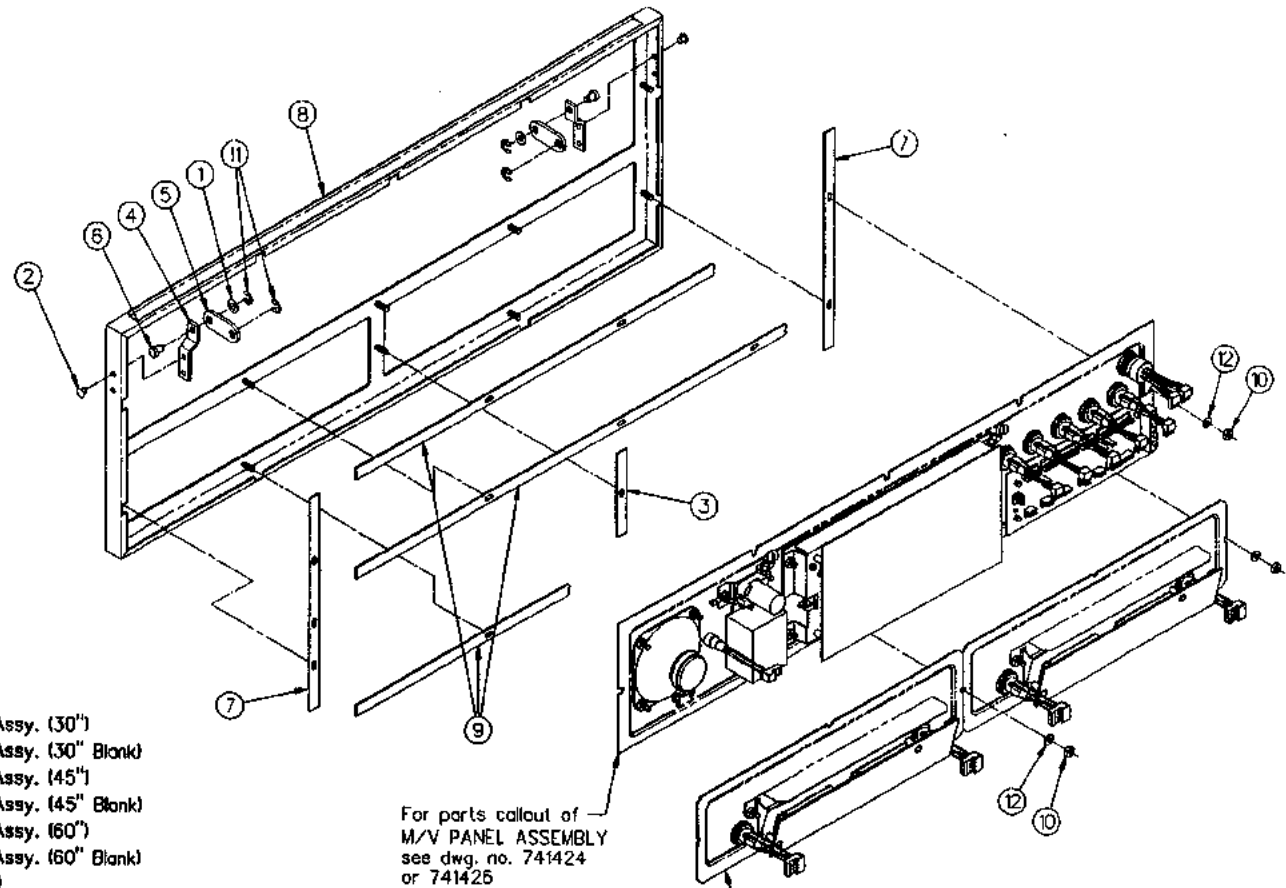

For parts callout of
PPG PANEL ASSEMBLY
see dwg. no. 741425

4-741284

PRICE PER GALLON PANEL ASSY. (FRONT LIT)

MODEL 300, 400 & 600 SERIES

Item No.	Part No.	Name Of Part
1	2-228671	#10-24 Capped Washer Lock Nut
2	228678-1	Push Button Switch Assy.
	2-228667	Red Lens (Only)
	4-228667	Bezel & Seal Assembly
	4-224893	Lamp (Only)
	230157-1	Push Button Seal Kit
3	1-229240	Insulator PPG Board
	4-315187	Liquid Crystal Display
5	1-317483	Reflector
6	318203-1	Dial & Window Assy. (Cash)
	318203-2	Dial & Window Assy. (Cash/Credit)
	3-418208	Dial Blank
	418193-1	Cash/Credit PPG Display Board Assy. (Includes Item # 4)
7	418193-2	Cash PPG Display Board Assy. (Includes Item # 4)
	418500-1	Mask Weld Assembly (PPG)
8	90-50301	#6-32 X 5/16 Lg. Rd. Hd. Moch Screw
9	03-50761	#6 Lockwasher
10		

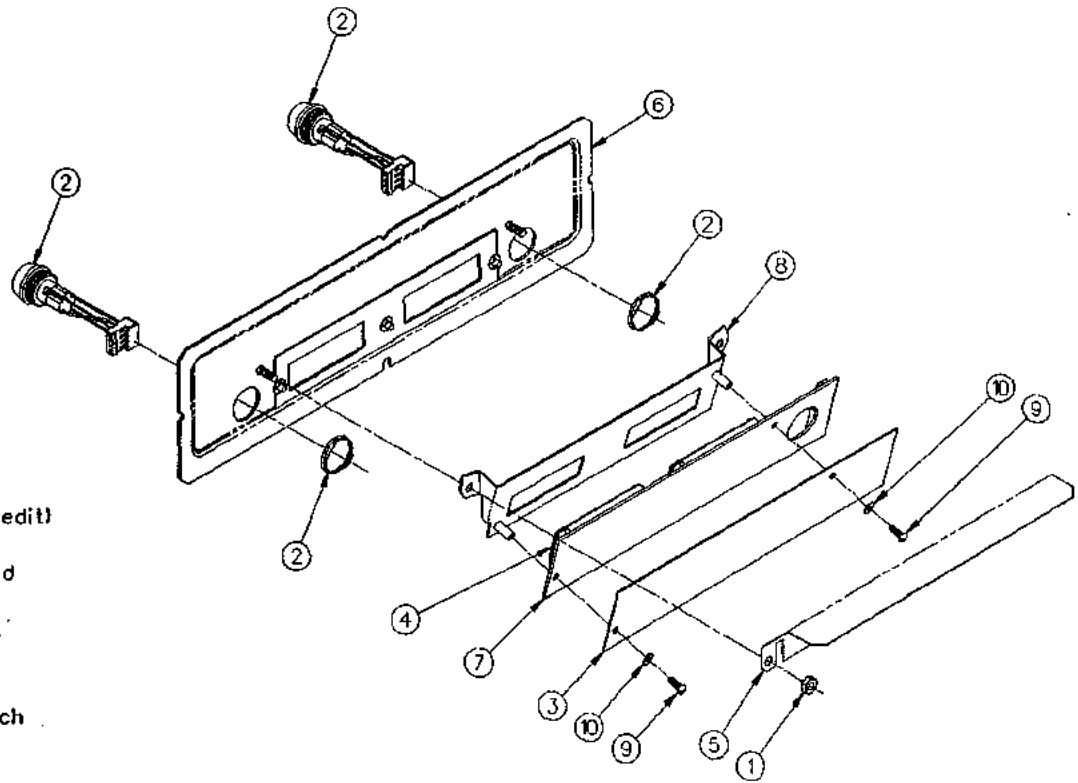

MONEY/VOLUME PANEL ASSY. (FRONT LIT)

(SERIAL NO. 108-15757 & BELOW)
MODEL 300, 400 & 600 SERIES

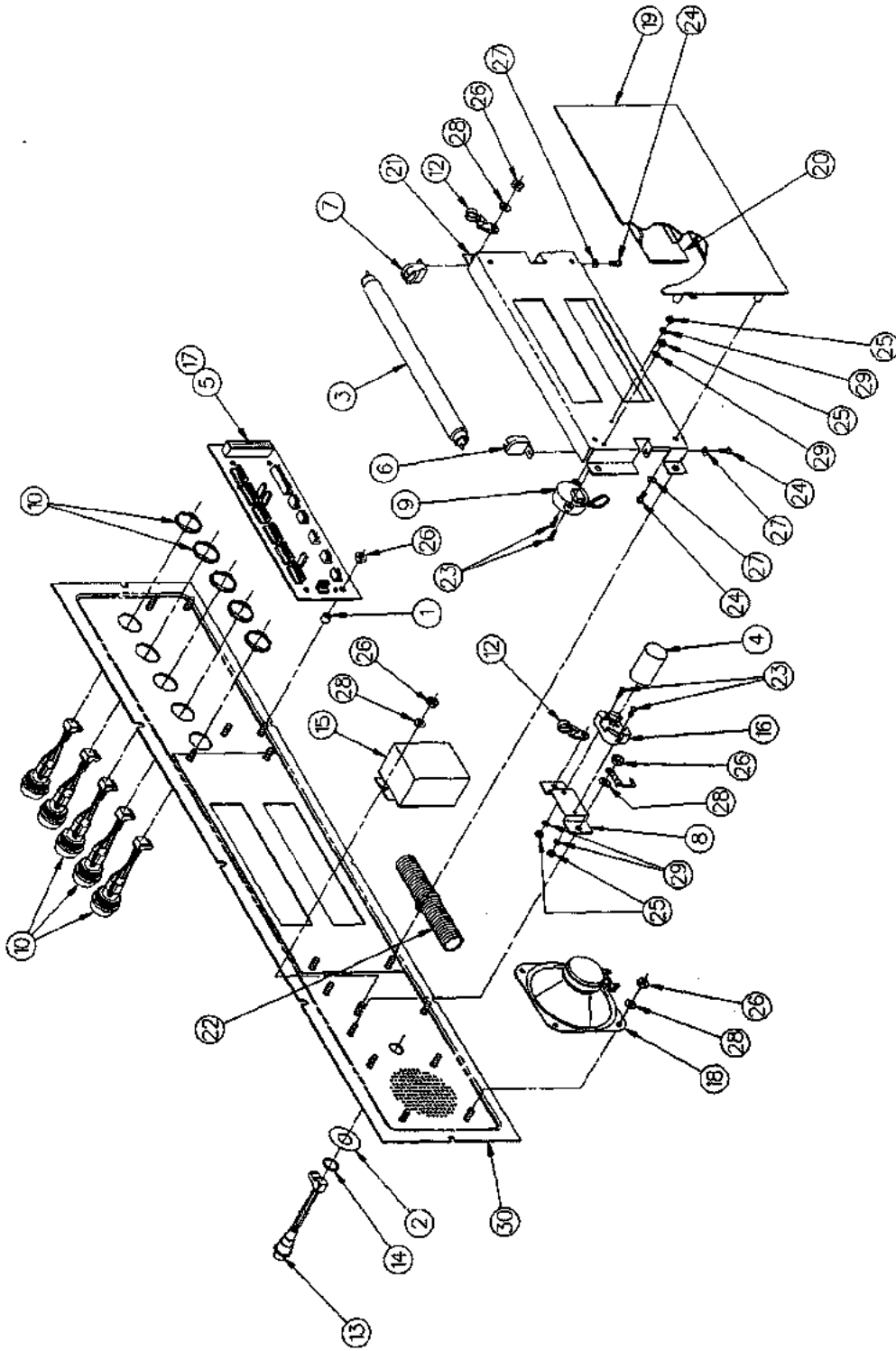

1-741424

MONEY/VOLUME PANEL ASSEMBLY (Front Lit)

For Models 300, 400, & 600 - Serial No. 108-15757 & Below

ITEM NO.	PART NO.	DESCRIPTION	ITEM NO.	PART NO.	DESCRIPTION	ITEM NO.	PART NO.	DESCRIPTION	
1	3-131460	Spacer	18	1-318170	Speaker	30	<u>Dial & Window Assembly</u>		
2	1-131941	Assistance Plate	19	<u>Money/Volume Board Assembly</u>		419154-1	30" Front		
3	11-219435	Fluorescent Lamp		<u>(Includes Item #20)</u>		419154-2	30" Rear		
4	1-226278	Starter		418047-1	110 Volt	419154-3	45" Front		
5	2-227359	Connector (2 Pin)	418047-2	220 Volt	419154-4	45" Rear			
6	1-227766	Lamp Holder	20	<u>Liquid Crystal Display</u>		419154-5	60" Front		
7	3-227766	Lamp Holder		1-418086 110 Volt		419154-6	60" Rear		
8	1-228676	Starter Socket		2-418086 220 Volt		419154-14	30"-P Rear		
9	228677-1	Buzzer Assembly (Annunciator)	21	1-418189	Mask (Money/Volume)	419154-18	45"-P Rear		
						419154-19	45"-SP Front		
10	228678-2	Push Button Switch Assy.(Preset)	22	<u>Loom & Harness Assembly</u>		419154-20	45"-SP Rear		
				2-228667	418658-1 30" Front		419154-22	60"-P Rear	
				4-228667	418658-2 30" Rear		419154-23	60"-SP Front	
				4-224893	418658-3 45" Front		419154-24	60"-SP Rear	
12	1-228918	Cable Clamp	23	30-50001	#4-40 x 3/8" Long Rd Hd Mach Screw	419154-25	30"-S Front		
						419154-26	30"-S Rear		
13	229459-1	Push Button Switch Assembly	24	90-50001	#6-32 x 5/16" Long Rd Hd Mach Screw	419154-27	45"-S Front		
						419154-28	45"-S Rear		
14	6-38210	"O" Ring	25	02-50211	#4-40 Hex Nut	419154-29	60"-S Front		
						419154-30	60"-S Rear		
						419154-40	30"-P Front		
						419154-41	30"-SP Front		
15	Ballast	110 Volt	26	05-50211	#10-24 Hex Nut	419154-42	30"-SP Rear		
						3-315556	240 Volt 50Hz		419154-45
16	1-315557	Starter Socket	27	03-50761	#6 Lockwasher	419154-50	60"-P Front		
						4-315556	240 Volt 60Hz		
17	317653-1	Dial Interconnect Board Assembly	28	05-50761	#10 Lockwasher				
						29	19-50761	#4 Lockwasher	

TCS/TCOA Dispenser Parts Manual
 Form 4576A Version 1.0
 Tokheim Corporation February 1996

MONEY/VOLUME PANEL ASSY. (FRONT LIT)

(SERIAL NO. 108-15758 & ABOVE)
MODEL 300, 400 & 600 SERIES

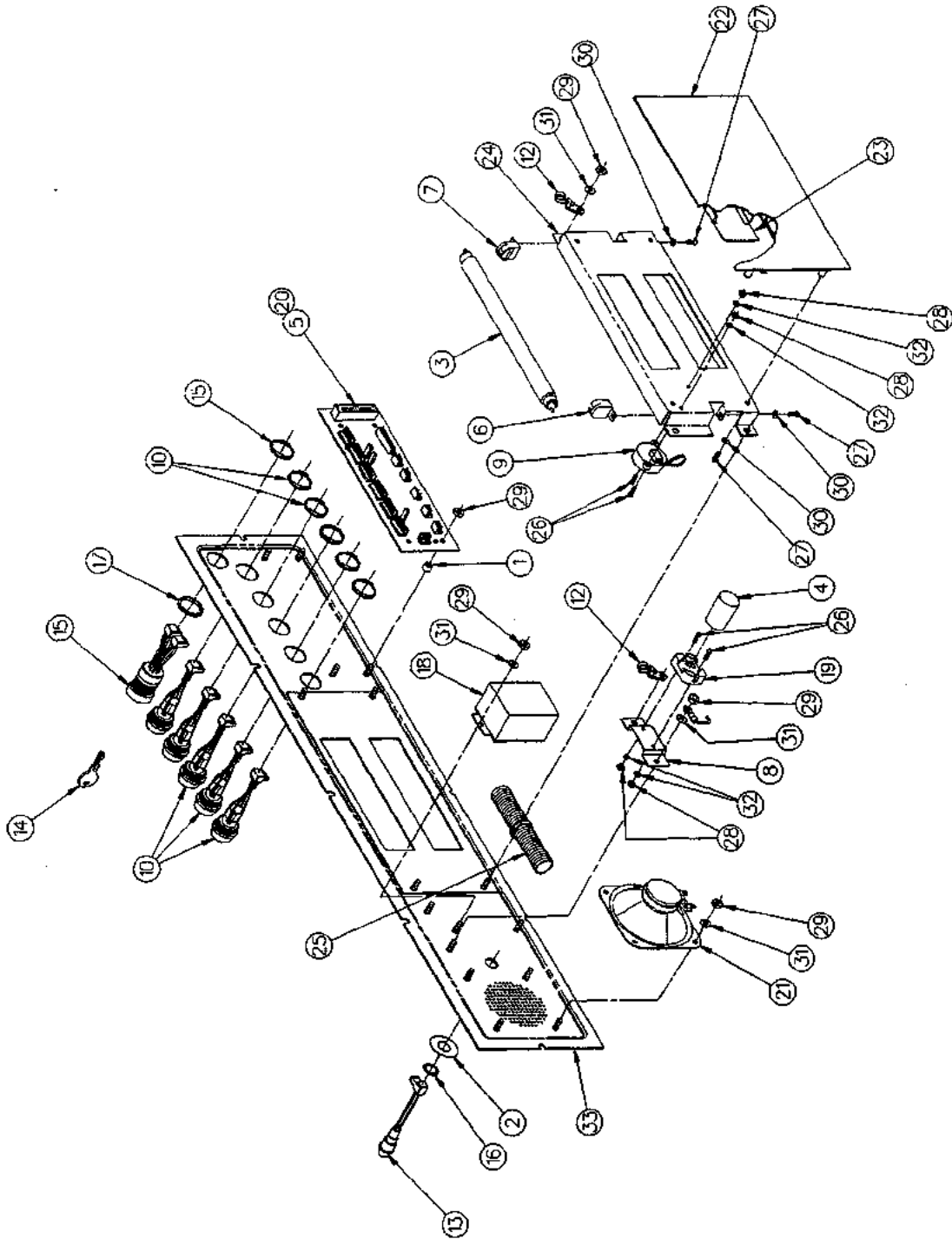

1-741426

1-741426

1 of 2

MONEY/VOLUME PANEL ASSEMBLY (Front Lit)**Model 300, 400, & 600 - Serial No. 108-15758 & Above**

ITEM NO.	PART NO.	DESCRIPTION	ITEM NO.	PART NO.	DESCRIPTION	ITEM NO.	PART NO.	DESCRIPTION
1	3-131460	Spacer	14	<u>Key</u>		23	<u>Liquid Crystal Display</u>	
2	1-131941	Assistance Plate		2-229680	Attendants (372I)		1-418086	110 Volt
3	11-219435	Fluorescent Lamp		3-229680	Managers (592T)		2-418086	220 Volt
4	1-226278	Starter	15	229681-1	Keylock Switch & Harness Assy (Includes Item # 14)	24	1-418189	Mask (Money/Volume)
5	2-227359	Connector (2 Pin)				25	<u>Loom & Harness Assembly</u>	
6	1-227766	Lamp Holder	16	6-38210	"O" Ring		418658-1	30" Front
7	3-227766	Lamp Holder	17	7-38210	"O" Ring		418658-2	30" Rear
8	1-228676	Starter Socket Mounting Brckt	18	<u>Ballast</u>			418658-3	45" Front
9	228677-1	Buzzer Assembly (Annunciator)		1-315556	110 Volt		418658-4	45" Rear
10	228678-2	Push Button Switch Assy.(Preset)		3-315556	240 Volt 50Hz		418658-5	60" Front
	2-228667	Red Lens Only		4-315556	240 Volt 60Hz	26	30-50001	#4-40 x 3/8" Long Round Head Machine Screw
	4-228667	Bezel & Seal Assembly	19	1-315557	Starter Socket	27	90-50001	#6-32 x 5/16" Long Round Head Machine Screw
	4-224893	Lamp Only	20	317653-1	Dial Interconnect Board Assembly			
	230157-1	Push Button Seal Kit	21	1-318170	Speaker	28	02-50211	#4-40 Hex Nut
12	1-228918	Cable Clamp	22	<u>Money/Volume Board Assembly (Includes Item #23)</u>		29	05-50211	#10-24 Hex Nut
13	229459-1	Push Button Switch Assy		418047-1	110 Volt	30	03-50761	#6 Lockwasher
				418047-2	220 Volt	31	05-50761	#10 Lockwasher
						32	19-50761	#4 Lockwasher

Continued on the next page.

MONEY/VOLUME PANEL ASSEMBLY (Front Lit) - Continued**Model 300, 400, & 600 - Serial No. 108-15758 & Above**

ITEM NO.	PART NO.	DESCRIPTION	ITEM NO.	PART NO.	DESCRIPTION	ITEM NO.	PART NO.	DESCRIPTION
33		<u>Dial & Window Assembly</u>						
	419154-2	30" Rear	419154-16	30"-SP Rear (No Assistance Button)	419154-38	30"-S Front (No Assistance Button)		
	419154-4	45" Rear	419154-17	45"-P Front	419154-39	30"-S Front		
	419154-6	60" Rear	419154-18	45"-P Rear	419154-42	30"-SP Rear		
	419154-7	30"-S Front (No Assistance Button)	419154-20	45"-SP Rear	419154-43	30"-SP Front (No Assistance Button)		
	419154-8	30"-S Rear (No Assistance Button)	419154-21	60"-P Front				
	419154-9	45"-S Front (No Assistance Button)	419154-22	60"-P Rear	419154-44	30"-SP Front		
	419154-10	45"-S Rear (No Assistance Button)	419154-24	60"-SP Rear (No Assistance Button)	419154-47	45"-SP Rear		
	419154-11	60"-S Front (No Assistance Button)	419154-26	30"-S Rear	419154-48	45"-SP Front (No Assistance Button)		
	419154-12	60"-S Rear (No Assistance Button)	419154-28	45"-S Rear	419154-49	45"-SP Front		
	419154-13	30"-P Front	419154-30	60"-S Rear	419154-52	60"-SP Rear		
	419154-14	30"-P Rear	419154-31	45" Front	419154-53	60"-SP Front (No Assistance Button)		
	419154-15	30"-SP Front (No Assistance Button)	419154-32	45"-S Front (No Assistance Button)	419154-54	60"-SP Front		
			419154-33	45"-S Front				
			419154-34	60" Front				
			419154-35	60"-S Front (No Assistance Button)				
			419154-36	60"-S Front				
			419154-37	30" Front				

1-741426

BACK LIT DIAL ASSEMBLY (THREE PIECE)

MODEL 300A, 400A & 600A SERIES

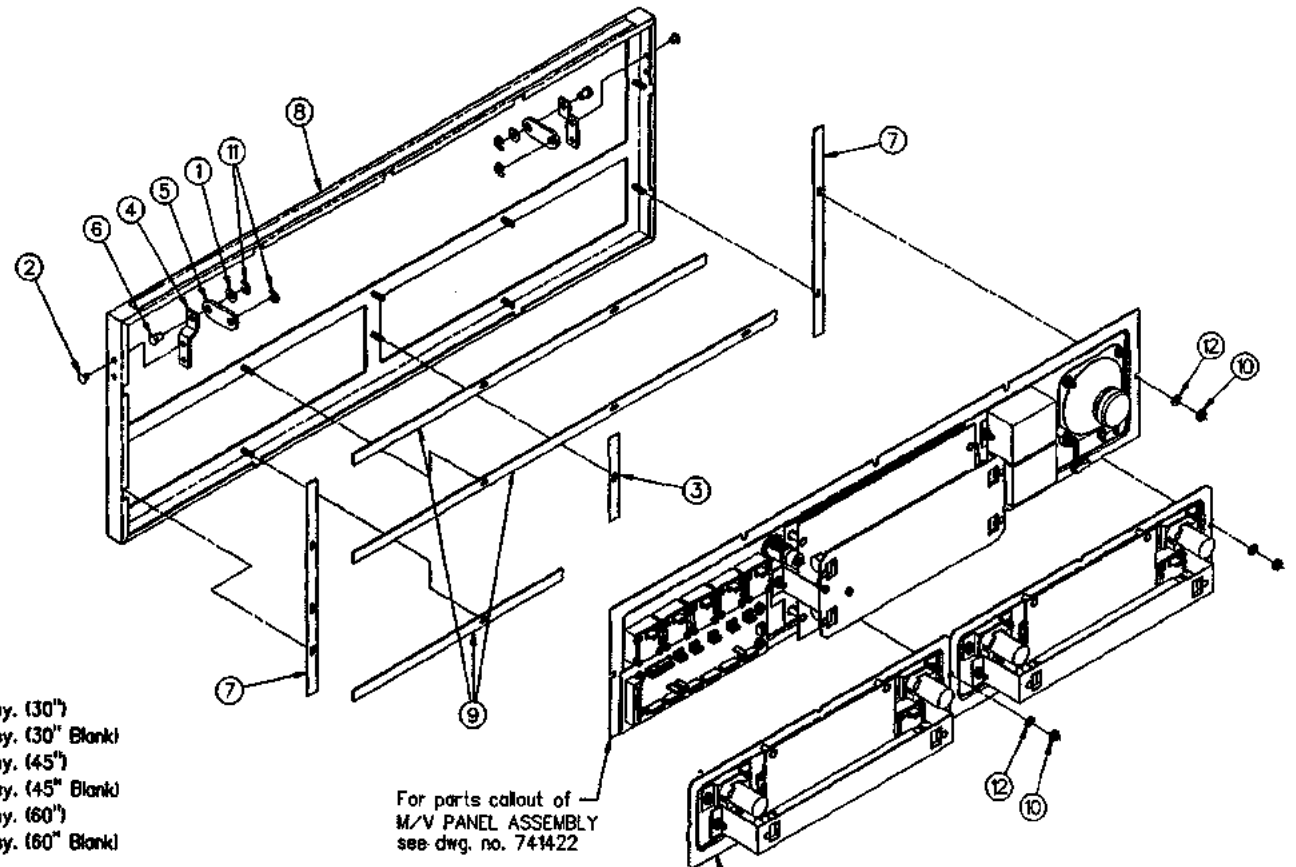

Item No.	Part No.	Name Of Part
1	1-126816	Washer
2	1-131006	Pop Rivet
3	1-131571	Sealing Strip
4	1-228640	Bracket
5	1-228641	Link
6	1-231143	Pin
7	1-228675	Sealing Strip
8	418130-1	Dial Frame Weld Assy. (30")
	418130-2	Dial Frame Weld Assy. (30" Blank)
	418132-1	Dial Frame Weld Assy. (45")
	418132-2	Dial Frame Weld Assy. (45" Blank)
	418134-1	Dial Frame Weld Assy. (60")
	418134-2	Dial Frame Weld Assy. (60" Blank)
9	1-418535	Sealing Strip (60")
	1-418536	Sealing Strip (45")
	1-418537	Sealing Strip (30")
10	05-50211	#10-24 Hex Nut
11	06-52482	Truarc "E" Retaining Ring
12	05-50621	#10 Plain Washer

For parts callout of
 M/V PANEL ASSEMBLY
 see dwg. no. 741422

For parts callout of
 PPG PANEL ASSEMBLY
 see dwg. no. 741423

3-741313

PRICE PER GALLON PANEL ASSEMBLY (BACK LIT)
MODEL 300A, 400A & 600A SERIES

MGR Name SIS

password 0080080

1 2 3 _

4 5 6

7 8 9

0 0 0

Help
Cancel
Receipt
No

Power out
pay cash in
pay Ins
Credit
Receipt
Yes

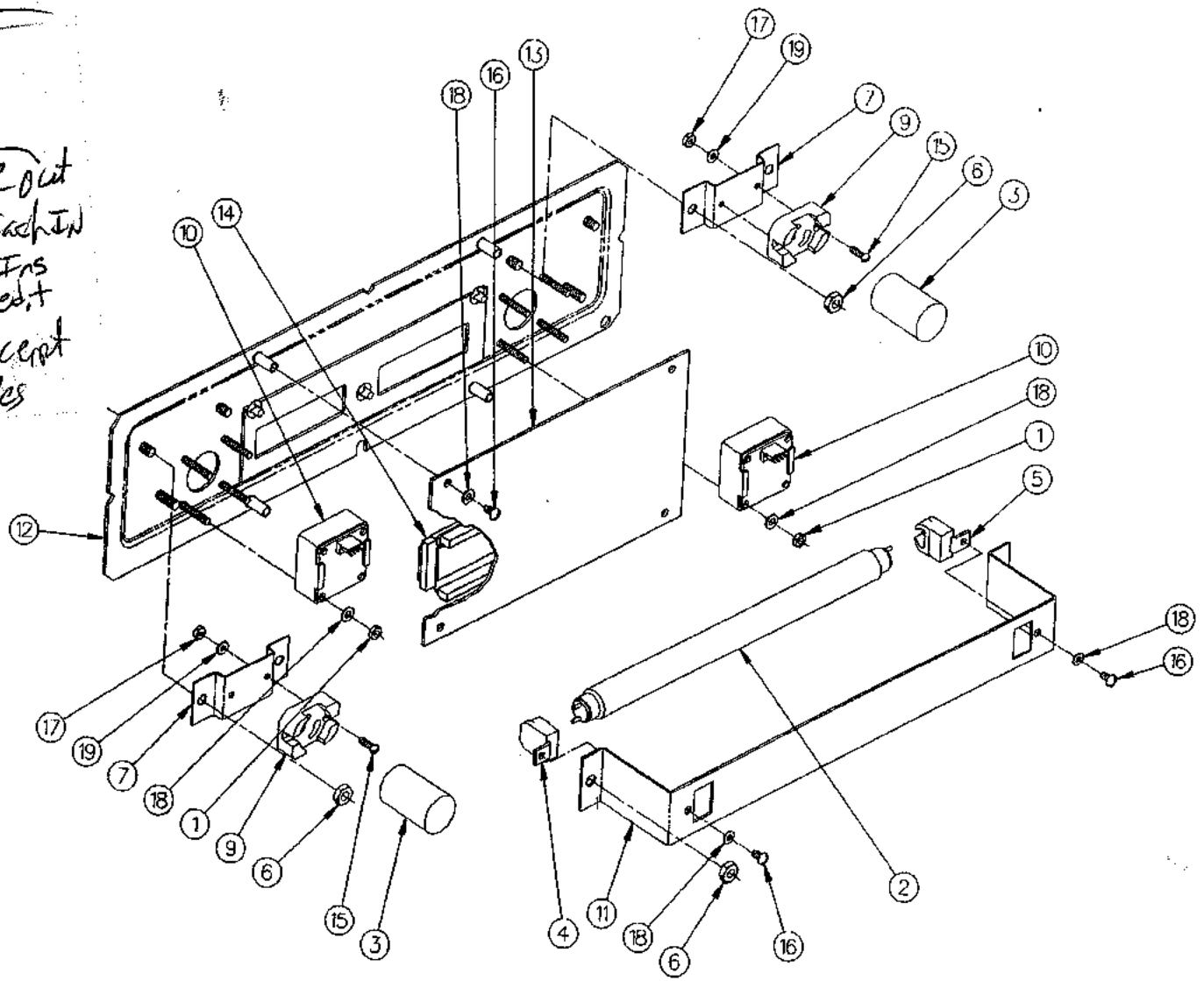

TCS/TCSA Dispenser Parts Manual
Form 4576A Version 1.0
Tadheim Corporation February 1996

3-741423

**PRICE PER GALLON PANEL ASSEMBLY (BACK LIT)
MODEL 300A, 400A & 600A SERIES**

ITEM NO.	PART NO.	DESCRIPTION
1	1-128791	#6-32 Special Nut
2	11-219435	Fluorescent Lamp
3	1-226278	Starter
4	1-227766	Lamp Holder
5	3-227766	Lamp Holder
6	2-228671	#10-24 Capped Washer Locknut
7	1-228676	Starter Socket Mounting Bracket
8	1-229621	Switch Grommet
9	1-315557	Starter Socket
10	<u>Push Button Switch Assembly</u> <i>Push to start</i>	
	1-319195	Red Unlighted
	2-319195	Red Lighted
11	1-318319	Price Per Gallon Light Bracket
12	<u>Dial & Window Assembly</u>	
	318203-3	Cash
	318203-4	Cash/Credit
	318203-5	Dial Blank

ITEM NO.	PART NO.	DESCRIPTION
13	<u>Price Per Gallon Display Board Assembly</u> (Includes Item #14)	
	419202-1	Cash/Credit (Decimals)
	419202-2	Cash (Decimals)
	419202-3	Cash/Credit (Commas)
	419202-4	Cash (Commas)
14	2-419225	Liquid Crystal Display
15	30-50001	#4-40 x 3/8" Long Round Head Machine Screw
16	90-50001	#6-32 x 5/16" Long Round Head Machine Screw
17	02-50211	#4-40 Hex Nut
18	03-50761	#6 Lockwasher
19	19-50761	#4 Lockwasher

3-741423

TCS/TCSA Dispenser Parts Manual
Form 4576A Version 1.0
Tokheim Corporation February 1996

MONEY/VOLUME PANEL ASSY. (BACK LIT)
 MODEL 300A, 400A & 600A SERIES

Inte car

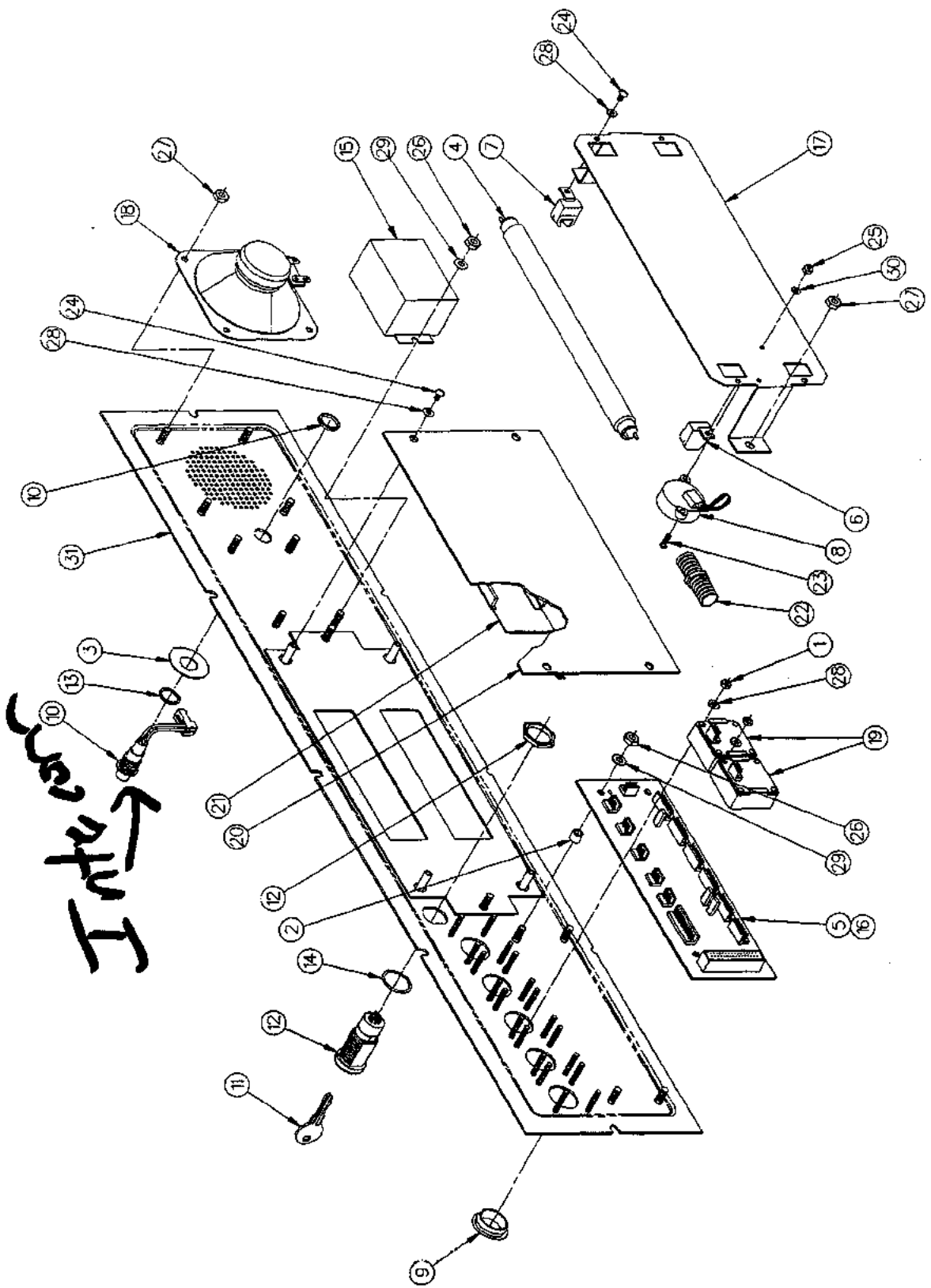

1-741422

MONEY/VOLUME PANEL ASSY. (BACK LIT)

MODELS 300A, 400A & 600A SERIES

ITEM NO.	PART NO.	DESCRIPTION	ITEM NO.	PART NO.	DESCRIPTION	ITEM NO.	PART NO.	DESCRIPTION
1	1-128791	#6-32 Special Nut	19	<u>Push Button Switch Assembly</u>		31	<u>Dial & Window Assembly</u>	
2	3-131460	Spacer		1-319195	Red (Unlighted)		420248-1	30"A Front
3	1-131941	Assistance Plate		2-319195	Red (Lighted)		420248-2	30"A Rear
4	11-219435	Fluorescent Lamp					420248-3	45"A Front
5	2-227359	Connector (2 Pin)	20	<u>Money/Volume Board Assembly</u>			420248-4	45"A Rear
6	1-227766	Lamp Holder		<u>(Includes Item #21)</u>			420248-5	60"A Front
7	3-227766	Lamp Holder		419091-1	Decimals		420248-6	60"A Rear
8	228677-1	Buzzer Assembly (Annunciator)		419091-2	Commas		420248-7	30"A-S Front
9	1-229621	Switch Grommet	21	3-419225	Liquid Crystal Display		420248-8	30"A-S Rear
10	229459-1	Push Button Switch Assembly					420248-9	45"A-S Front
							420248-10	45"A-S Rear
			22	<u>Loom & Harness Assembly</u>			420248-11	60"A-S Front
11	Key			419763-1	30"A Front		420248-12	60"A-S Rear
	2-229680	Attendants (372I)		419763-2	30"A Rear		420248-13	30"A-P Front
	3-229680	Managers (592I)		419763-3	45"A Front		420248-14	30"A-P Rear
				419763-4	45"A Rear		420248-15	30"A-SP Front
12	230187-1	Keylock Switch & Harness Assembly (Includes Item # 11)		419763-5	60"A Front		420248-16	30"A-SP Rear
				419763-6	60"A Rear		420248-17	45"A-P Front
							420248-18	45"A-P Rear
13	6-38210	"O" Ring	23	30-50001	#4-40 x 3/8" Lg Rd Hd Mach Screw		420248-19	45"A-SP Front
14	7-38210	"O" Ring					420248-20	45"A-SP Rear
			24	90-50001	#6-32 x 5/16" Lg Rd Hd Mach Screw		420248-21	60"A-P Front
15	Ballast						420248-22	60"A-P Rear
	1-315556	110 Volt	25	02-50211	#4-40 Hex Nut		420248-23	60"A-SP Front
	3-315556	240 Volt 50Hz	26	05-50211	#10-24 Hex Nut		420248-24	60"A-SP Rear
	4-315556	240 Volt 60Hz	27	2-228671	#10-24 Capped Washer Lock Nut		420248-25	45"A-S Front
								(No Assistance Button)
16	317653-1	Dial Interconnect Board Assembly	28	03-50761	#6 Lockwasher		420248-26	45"A-S Rear
			29	05-50761	#10 Lockwasher			(No Assistance Button)
17	1-318152	Money/Volume Light Bracket	30	19-50761	#4 Lockwasher		420248-27	45"A-SP Front
								(No Assistance Button)
18	1-318170	Speaker					420248-28	45"A-SP Rear
								(No Assistance Button)

Continued on the next page.

MONEY/VOLUME PANEL ASSY. (BACK LIT) - Continued

MODELS 300A, 400A & 600A SERIES

ITEM NO.	PART NO.	DESCRIPTION	ITEM NO.	PART NO.	DESCRIPTION
31	<i>Dial & Window Assembly (continued)</i>		31	<i>Dial & Window Assembly (continued)</i>	
	420248-29	45"A Front (No Stop Button)		420761-4	45"A-ST Front (No Assistance Button)
	420248-30	45"A Rear (No Stop Button)		420761-5	45"A-ST Rear (No Assistance Button)
	420248-31	60"A-S Front (No Assistance Button)		420761-6	45"A-SPT Front (No Assistance Button)
	420248-32	60"A-S Rear (No Assistance Button)		420761-7	45"A-SPT Rear (No Assistance Button)
	420248-33	60"A-SP Front (No Assistance Button)		420761-8	60"A-T Front
	420248-34	60"A-SP Rear (No Assistance Button)		420761-9	60"A-T Rear
	420248-35	30"A-S Front (No Assistance Button)		420761-10	60"A-PT Front
	420248-36	30"A-S Rear (No Assistance Button)		420761-11	60"A-PT Rear
	420248-37	30"A-SP Front (No Assistance Button)		420761-12	60"A-ST Front
	420248-38	30"A-SP Rear (No Assistance Button)		420761-13	60"A-ST Rear
	420248-39	30"A Front (No Stop Button)		420761-14	60"A-SPT Front
	420248-40	30"A Rear (No Stop Button)		420761-15	60"A-SPT Rear
	420248-41	45"A-T Front		420761-16	60"A-ST Front (No Assistance Button)
	420248-42	45"A-T Rear		420761-17	60"A-ST Rear (No Assistance Button)
	420248-43	45"A-PT Front		420761-18	60"A-SPT Front (No Assistance Button)
	420248-44	45"A-PT Rear		420761-19	60"A-SPT Rear (No Assistance Button)
	420248-45	45"A-ST Front			
	420761-1	45"A-ST Rear			
	420761-2	45"A-SPT Front			
	420761-3	45"A-SPT Rear			

2-741422

SPEAKER & PRESETS ASSEMBLY

MODEL TCS "A" (ONE PIECE DIAL)

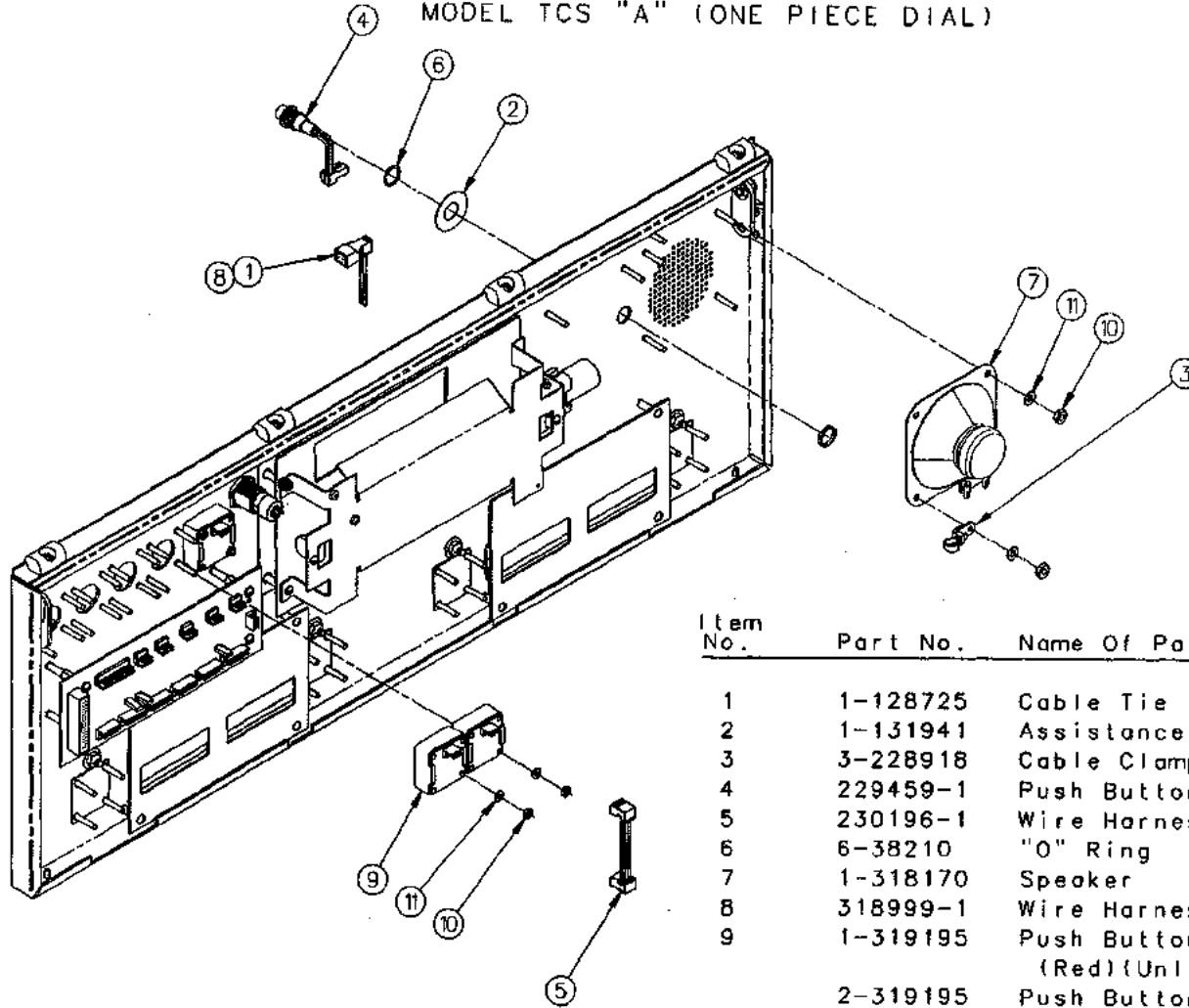

Item No.	Part No.	Name Of Part
1	1-128725	Cable Tie
2	1-131941	Assistance Plate
3	3-228918	Cable Clamp
4	229459-1	Push Button Switch Assy.
5	230196-1	Wire Harness Assembly
6	6-38210	"O" Ring
7	1-318170	Speaker
8	318999-1	Wire Harness Assembly
9	1-319195	Push Button Switch Assy. (Red)(Unlighted)
	2-319195	Push Button Switch Assy. (Red)(Lighted)
	3-319195	Push Button Switch Assy. (Gray)(Unlighted)
10	03-50211	#6-32 Hex Nut
11	03-50761	#6 Shakeproof Lockwasher

HIGH CASH/CREDIT BUTTON ASSEMBLY
 (FOR TCS ONE PIECE DIAL)

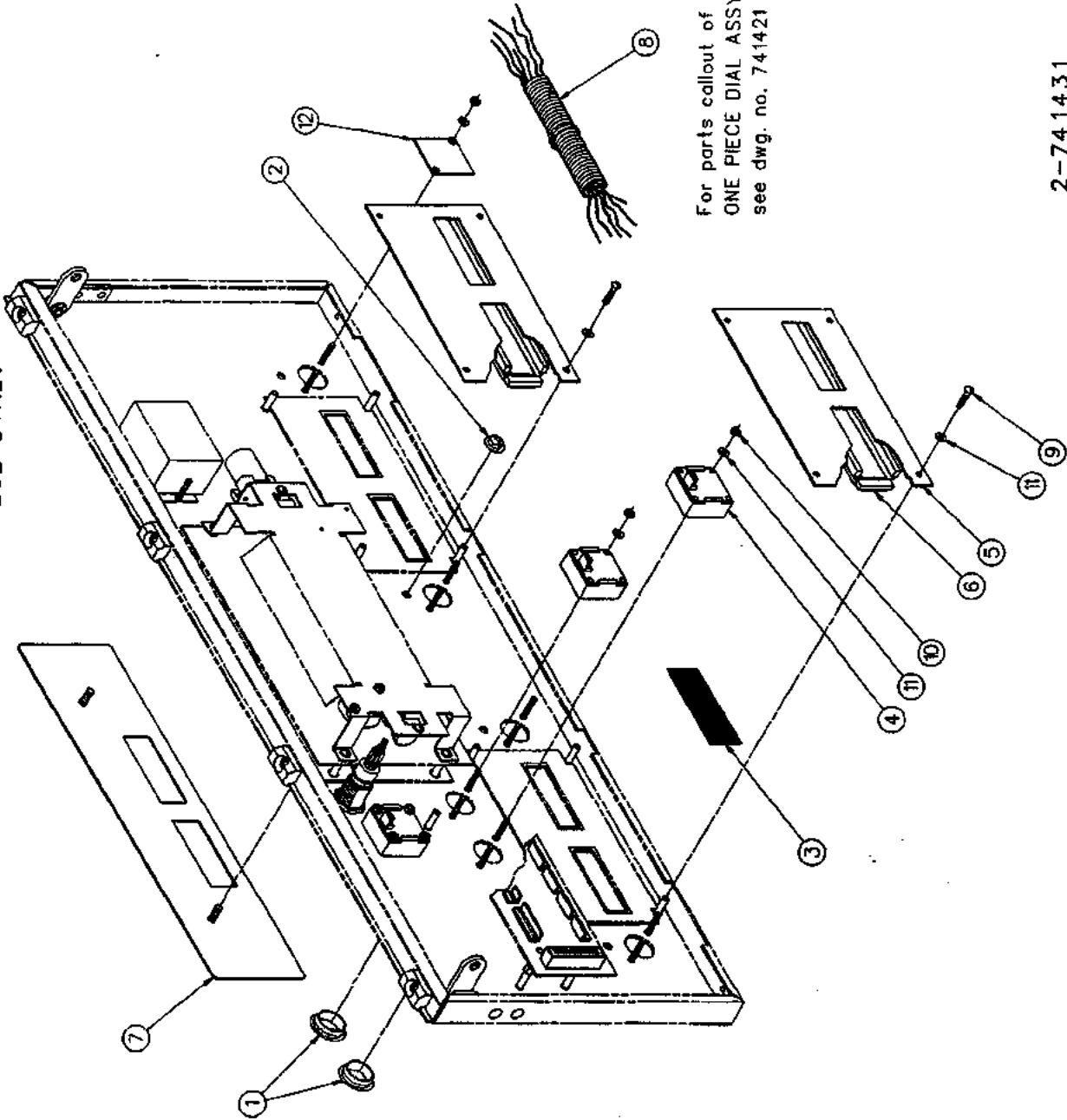

For parts callout of
 ONE PIECE DIAL ASSY.
 see dwg. no. 741421

2-741431

2-741431

1 of 1

HIGH CASH/CREDIT BUTTON ASSEMBLY (TCS ONE PIECE DIAL)

ITEM NO.	PART NO.	DESCRIPTION
1	1-229621	Switch Grommet
2	1-230432	#10-24 Capped Washer Locknut (With Seal)
3	1-230810	Light Filter
4	<u>Push Button Switch Assembly</u>	
	1-319195	Red (Unlighted)
	2-319195	Red (Lighted)
	3-319195	Gray (Unlighted)(Mobil)
5	<u>Board Assembly (Includes Item #6)</u>	
	419202-5	Cash/Credit (Decimals)
	419202-6	Cash (Decimals)
	419202-7	Cash/Credit (Commas)
	419202-8	Cash (Commas)
6	2-419225	Liquid Crystal Display
7	<u>Panel Weld Assembly</u>	
	420436-3	Cash/Credit
	420436-4	Cash
	420436-5	Blank
8	<u>Wiring Harness Assembly</u>	
	420495-1	45"
	420495-3	30"
	420495-6	60"
9	90-50001	#6-32 x 5/16" Long Round Head Machine Screw
10	03-50211	#6-32 Hex Mach Nut
11	03-50761	#6 Shakeproof Lockwasher
12	1-230798	Cash/Credit Plug

 2-741431

LOW CASH/CREDIT BUTTON ASSEMBLY
(FOR TCS ONE PIECE DIAL)

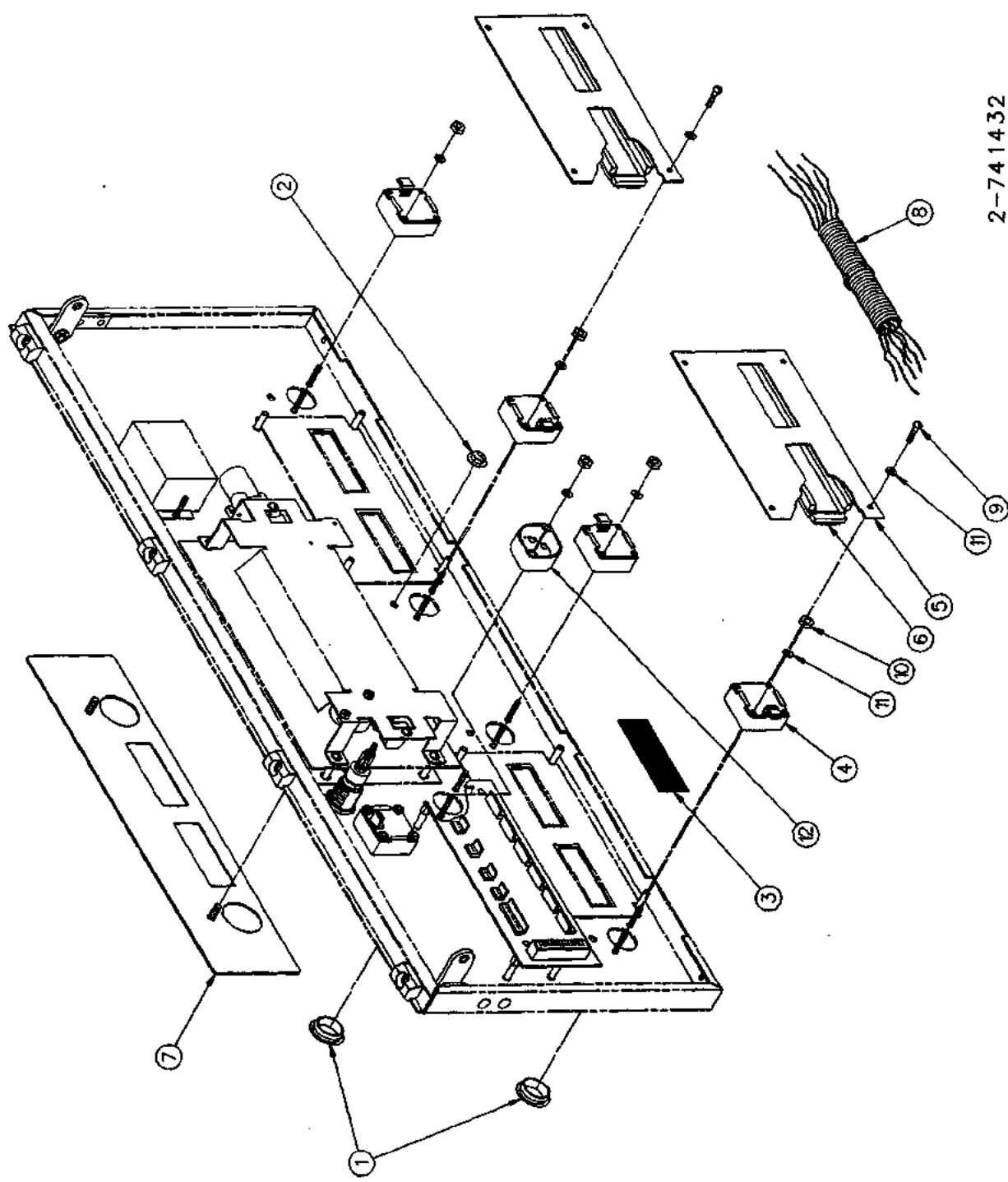

2-741432

ONE PIECE DIAL ASSEMBLY (BACK LIT)
(MODEL: TCS 30"A, 45"A & 60"A)

ITEM NO.	PART NO.	DESCRIPTION	ITEM NO.	PART NO.	DESCRIPTION	ITEM NO.	PART NO.	DESCRIPTION
1	2-128725	Cable Tie	24	<u>Ballast</u>		35	96-50001	#6-32 x 1/2" Lg Rd Hd Mach Screw
2	1-128791	#6-32 Special Nut		1-315556	110 Volt			
3	1-129223	Wire Connector		3-315556	220 Volt 50Hz	36	256-50001	#10-24 x 3/4" Lg Rd Hd Mach Screw
4	1-131006	Pop Rivet		4-315556	220 Volt 60Hz			
5	2-131473	Socket	25	1-315557	Starter Socket	37	03-50761	#6 Shakeproof Lockwasher
6	11-219435	Flourescent Lamp	26	317653-1	Dial Interconnect Board Assembly	38	06-52482	Truarc Retaining Ring
7	1-226278	Starter				39	30-50001	#4 x 3/8" Lg Round Head Machine Screw
8	2-227359	Connector	27	<u>Push Button Switch Assembly</u>		40	02-50211	#4-40 Hex Nut
9	1-227766	Lamp Holder		1-319195	Red - Unlighted	41	01-50761	#4 Shakeproof Lockwasher
10	3-227766	Lamp Holder		2-319195	Red - Lighted			
11	1-228606	Connector Housing		3-319195	Gray - Unlighted	42	<u>Screened Dial & Plug Assembly</u>	
12	1-228640	Bracket					420769-1	30"A
13	1-228641	Link	28	318974-1	Bracket & Standoff Assembly		420769-2	30"A With Speaker
14	1-231143	Pin					420769-3	30"A With Speaker & Preset
15	228677-1	Buzzer Assembly (Annunclator)	29	<u>Dial Rail</u>			420769-4	45"A
16	1-229621	Switch Grommet		1-319013	60"		420769-5	45"A With Speaker
17	1-229652	Plastic Rivet		2-319013	45"		420769-6	45"A With Speaker & Preset
18	<u>Key</u>			3-319013	30"		420769-7	45"A With DPT
	2-229680	Attendants (372I)	30	1-319029	Dial Guide		420769-8	45"A With Speaker & DPT
	3-229680	Managers (592T)	31	<u>Money/Volume Board Assembly (includes Item #32)</u>			420769-9	45"A With Speaker, Preset & DPT
19	230187-1	Keylock Switch & Harness Assembly (Includes Item # 18)		419091-3	Decimals		420769-10	60"A
20	230196-1	Wire Harness Assembly		419091-4	Commas		420769-11	60"A With Speaker
21	1-230432	#10-24 Capped Washer Locknut (With Seal)	32	2-419225	Liquid Crystal Display		420769-12	60"A With Speaker & Preset
22	7-229606	Spacer	33	420165-21	Lead Assembly		420769-13	60"A With DPT
23	7-38210	"O" Ring	34	90-50001	#6-32 x 5/16" Lg Rd Mach Screw		420769-14	60"A With Speaker & DPT
							420769-15	60"A With Speaker, Preset & DPT

DIAL ASSEMBLY FOR 45" & 60" DPT

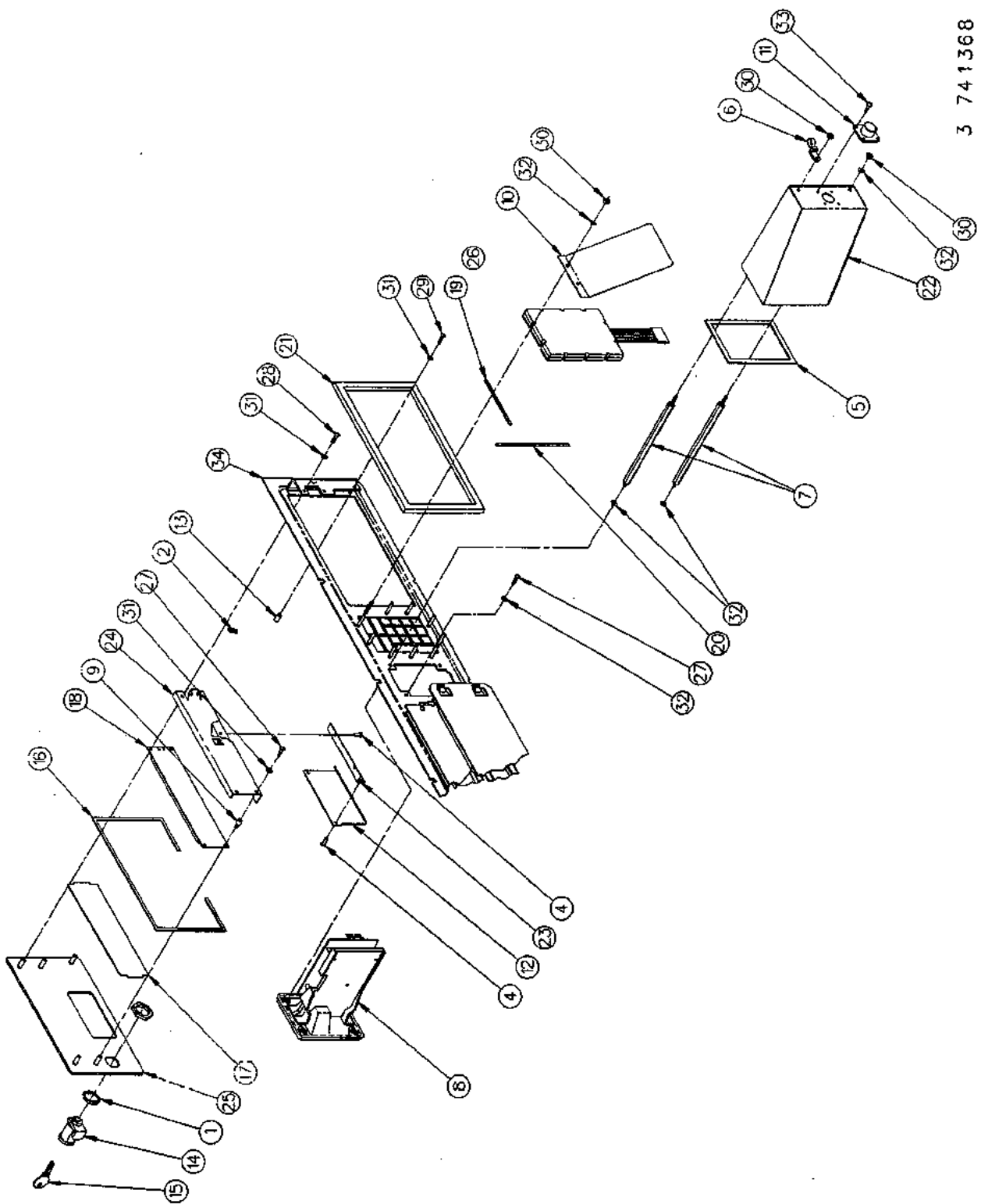

3 741368

LOW CASH/CREDIT BUTTON ASSEMBLY (TCS ONE PIECE DIAL)

ITEM NO.	PART NO.	DESCRIPTION
1	1-229621	Switch Grommet
2	1-230432	#10-24 Capped Washer Locknut (With Seal)
3	1-230810	Light Filter
4	<u>Push Button Switch Assembly</u>	
	2-319195	45" (Red)(Lighted)
	4-319195	30" & 60" (Red)(Lighted)
5	<u>Board Assembly (Includes Item #6)</u>	
	419202-5	Cash/Credit (Decimals)
	419202-6	Cash (Decimals)
	419202-7	Cash/Credit (Commas)
	419202-8	Cash (Commas)
6	2-419225	Liquid Crystal Display
7	<u>Panel Weld Assembly</u>	
	420436-1	Cash/Credit
	420436-2	Cash
	420436-5	Blank
8	<u>Wiring Harness Assembly</u>	
	420495-2	45"
	420495-4	30"
	420495-7	60"
9	90-50001	#6-32 x 5/16" Long Round Head Machine Screw
10	03-50211	#6-32 Hex Mach Nut
11	03-50761	#6 Shakeproof Lockwasher
12	1-318975	Cash/Credit Plug

ONE PIECE DIAL ASSEMBLY (MONEY/VOLUME)

(FOR TCS "A" SERIES)

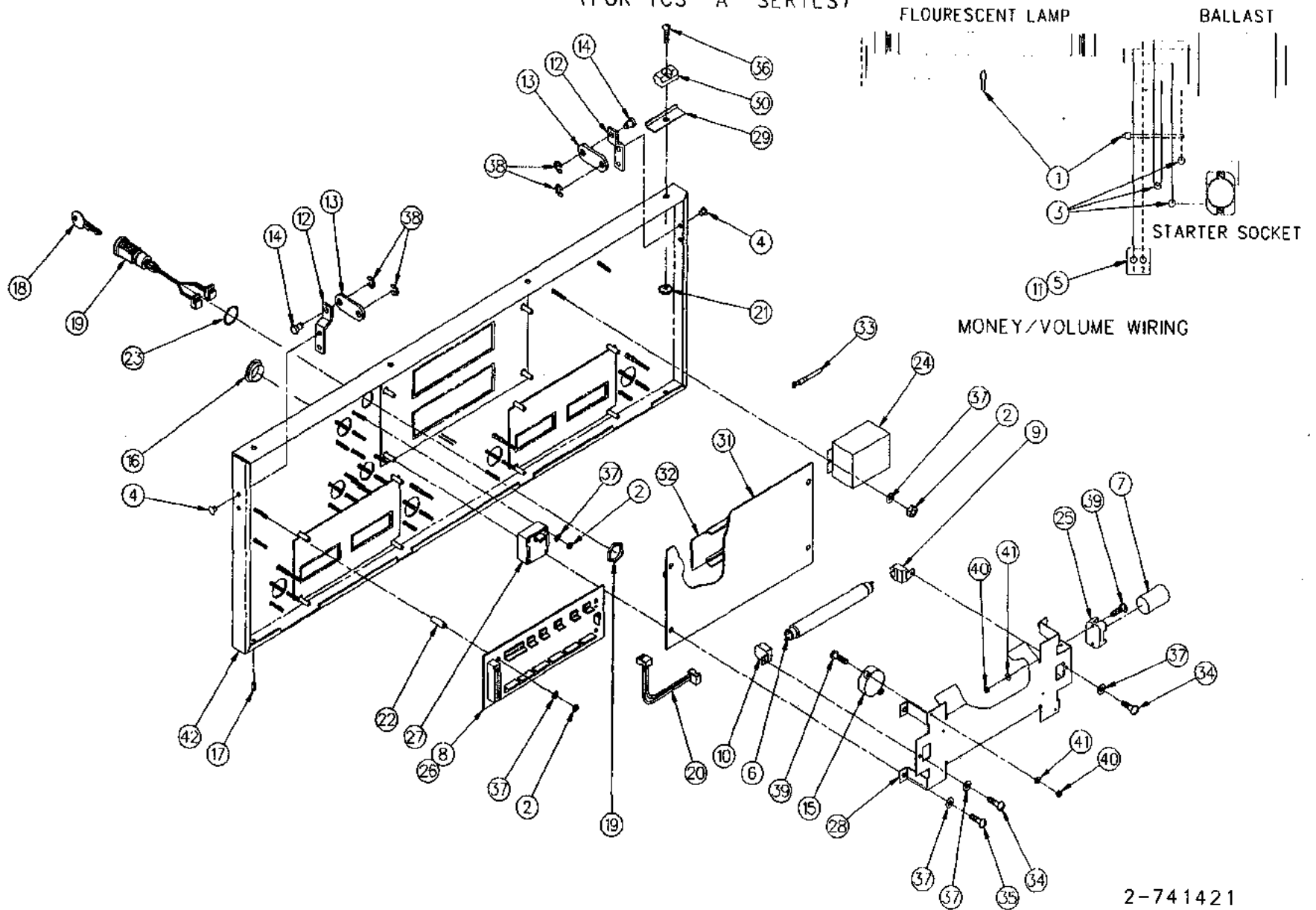

2-741421

DIAL ASSEMBLY FOR DPT For Models 400A, & 600A

ITEM NO.	PART NO.	DESCRIPTION	ITEM NO.	PART NO.	DESCRIPTION
1	2-127656	Lock Gasket	17	1-230688	LCD Window
2	1-128725	Cable Tie	18	231180-1	DPT Display Replacement Kit
3	<u>Decalcomania (Not Shown On Drawing)</u>		19	24-317638	Cushion
	1-131573	"HAND INSERTING CARD"	20	25-317638	Cushion
	1-230813	"THIS CARD READER ACCEPTS AND SELECTED ATM BANK DEBIT CARDS"	21	1-318827	Printer Box Gasket
	2-231099	"TEXACO"	22	318838-1	Box Assembly
	1-318917	"RECEIPT"	23	2-318895	Receipt Door Hinge
	2-318917	"TEXACO LOGO"	24	1-318898	LCD Cover
	3-318917	"TEXACO"	25	<u>Access Door Weld Assembly</u>	
	4-318917	"THIS CARDREADER ACCEPTS"		318901-2	All Except Mobil
	5-318917	"PUSH"		318901-4	Mobil
	6-318917	"CARDREADER INSTRUCTIONS"	26	<u>Membrane Keypad</u>	
	7-318917	"INSTRUCTIONS"		2-421173	Texaco & Generic DPT
	11-318917	"PHILLIPS LOGO"		3-421173	SuperAmerica
	12-318917	"INSERT CARD BELOW"		4-421173	Phillips
	13-318917	"INSERT CARD"		5-421173	Southland
4	1-132428	Pop Rivet		6-421173	Amoco
5	1-228470	Card Reader Gasket		7-421173	Amoco "Start"
6	3-228918	Cable Clamp		8-421173	Clark & Generic
7	2-228997	Rod		10-421173	Texaco Non Generic DPT
8	<u>Card Reader</u>			2-421176	Mobil
	3-229424	Mobil		3-421176	Emro
	4-229424	All Except Mobil	27	88-50001	#6-32 x 1/4" Long Round Head Machine Screw
9	7-229606	Spacer	28	90-50001	#6-32 x 5/16" Long Round Head Machine Screw
10	1-230461	Keypad Reflector	29	98-50001	#6-32 x 5/8" Long Round Head Machine Screw
11	230618-1	Internal Card Reader Wire Harness Assembly	30	03-50211	#6-32 Hex Nut
12	1-230681	Receipt Door	31	06-50641	#6 Lockwasher
13	1-230684	1/4" Standoff (Male-Female)	32	03-50761	#6 Shakeproof Lockwasher
14	1-230685	Lock	33	20-55392	#4 x 3/8" Long Hex Washer Head Tapping Screw
15	2-230685	Key (TPX 88)	34	<u>For parts callout of Dial Assembly see:</u>	
16	<u>Access Door Gasket</u>			731007	One Piece (Mobil)
	1-230686	All Except Mobil		741313	Three Piece
	1-231037	Mobil		741421	One Piece

TCS/TOSA Dispenser Parts Manual
Form 4576A Version 1.0
Tokheim Corporation February 1996

MODEL 322A-B5/B3 ONE PIECE DIAL ASSEMBLY

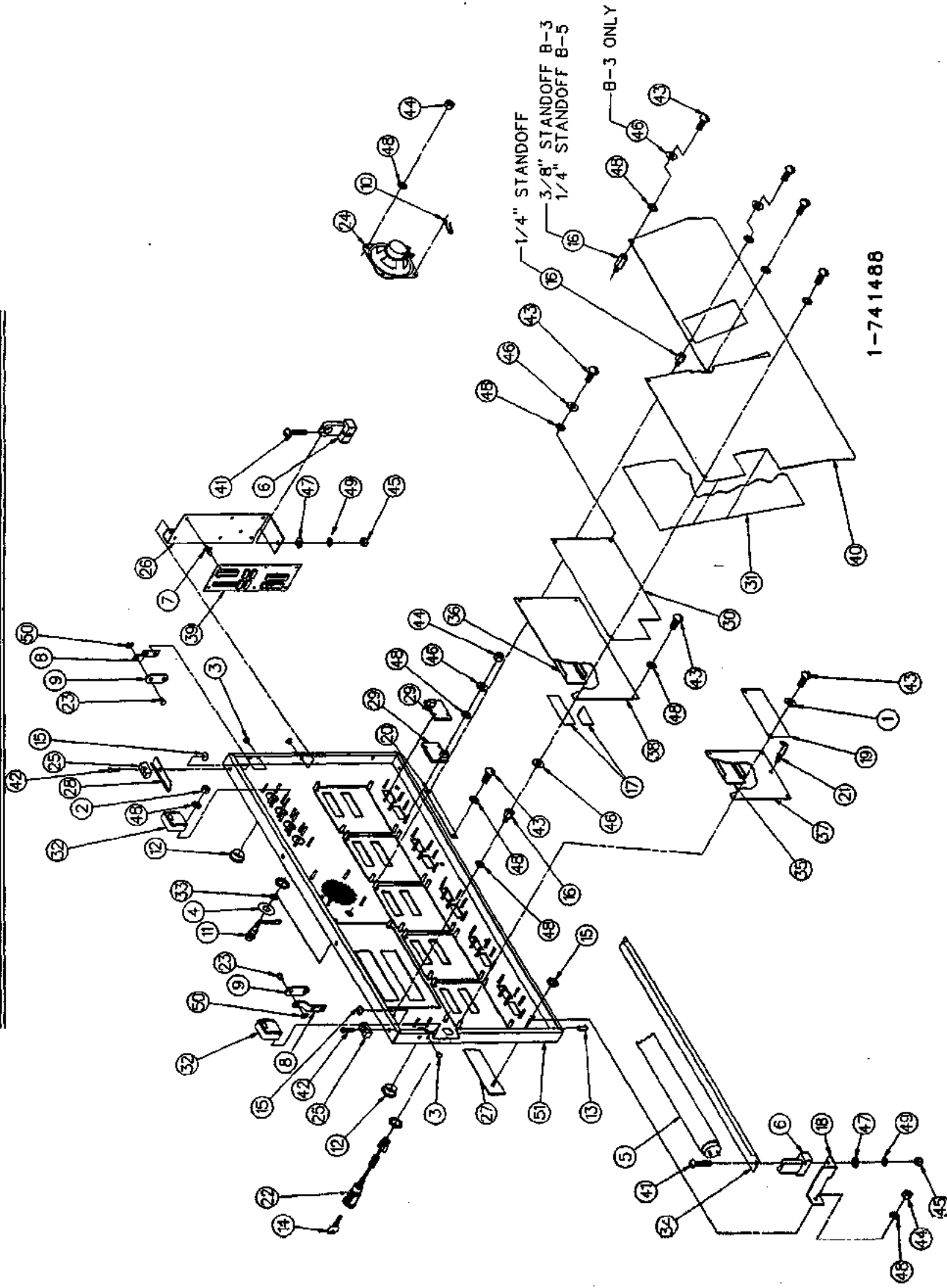

1-741488

322A-B3/5 ONE PIECE DIAL ASSEMBLY

ITEM NO.	PART NO.	DESCRIPTION	ITEM NO.	PART NO.	DESCRIPTION	ITEM NO.	PART NO.	DESCRIPTION
1	1-122705	Washer (K)						
2	1-128791	#6-32 Special Nut	22	231011-1	Keylock Switch	37		Volume)
3	1-131006	Pop Rivet			Harness Assembly			<u>Price/Unit Board Assembly</u>
4	1-131941	Assistance Plate			(Includes Items #14)			<u>(Includes Item #35)</u>
5	12-219435	Fluorescent Lamp	23	1-231143	Pin			420507-1 Cash/Credit
(Case)			24	1-318170	Speaker (SP)			(Decimals)
6	1-221379	Lamp Holder	25	1-319029	Dial Guide			420507-2 Cash (Decimals)
7	2-225470	Standoff	26	1-319101	PC Board Bracket			420507-3 Cash/Credit (Commas)
8	1-228640	Bracket						420507-4 Cash (Commas)
9	1-228641	Link	27		<u>Product Panel Weld Assembly</u>	38		<u>Money/Volume Board Assembly</u>
10	3-228918	Cable Clamp		319103-1	5 Product Blender			<u>(Includes Item #36)</u>
11	229459-1	Push Button Switch Assembly (SP)		319103-2	3 Product Blender			420513-1 Decimals
12	1-229621	Switch Grommet	28	3-319013	Dial Rail			420513-2 Commas
13	1-229652	Plastic Rivet	29		<u>Button</u>	39	420566-1	Switch Matrix Light Control
14	<u>Key</u>			2-319120	Credit	40	2-420673	Reflector
	2-229680	Attendant's		3-319120	Cash-No Printing	41	182-50001	#8-32 x 1" Long Round Head Machine Screw
	3-229680	Manager's			(VH322A-R-B5-SP/	42	256-50001	#10-24 x 3/4" Long Round Head Machine Screw
15	1-230432	Capped Washer Locknut (With Seal)	KSP)	4-319120	Credit-No Printing	43	88-50021	#6-32 x 1/4" Long Phillips Head Machine Screw
				5-319120	(VH322A-R-B5-K-SP)	44	03-50211	#6-32 Hex Nut
16		<u>Standoff (Male-Female)</u>	30	1-319161	Money/Volume Lens	45	04-50211	#8-32 Hex Nut
	1-230684	1/4" Long (B-3 & B-5)	31	1-319171	Reflector (Money/Volume Lens)	46	03-50621	#6 Plain Washer
	3-230684	3/8" Long (B-3)	32	2-319195	Push Button Switch	47	04-50621	#8 Plain Washer
17	1-230810	Light Filter	33	6-38210	"O" Ring	48	03-50761	#6 Shake-Proof Lockwasher
18	1-230959	Light Bracket	34	1-418298	Starter Strip	49	04-50761	#8 Shake-Proof Lockwasher
19	1-230973	Price Per Unit Lens	35	2-419225	Liquid Crystal Display (Price/Unit)	50	06-52482	Truarc Retaining Ring
20	1-230999	Insulator	36	3-419225	Liquid Crystal Display (Money/			
21	1-231007	Cable Clamp						

TCS/TCSA Dispenser Parts Manual
Form 4576A Version 1.0
Tokheim Corporation February 1996

322A-B3/5 ONE PIECE DIAL ASSEMBLY - Continued

10-28

ITEM NO.	PART NO.	DESCRIPTION	ITEM NO.	PART NO.	DESCRIPTION	ITEM NO.	PART NO.	DESCRIPTION
51		<u>Dial & Window Assembly</u>						
	420969-1	322A-B5						
	420969-2	322A-B5-K						
	420969-3	322A-B5-S						
	420969-4	322A-B5-KS						
	420969-5	322A-B5-P						
	420969-6	322A-B5-KP						
	420969-7	322A-B5-SP & VH322A-R-B5-SP						
	420969-8	322A-B5-KSP & VH322A-R-B5-KPS						
	420969-9	322A-B3						
	420969-10	322A-B3-K						
	420969-11	322A-B3-S						
	420969-12	322A-B3-KS						
	420969-13	322A-B3-P						
	420969-14	322A-B3-KP						
	420969-15	322A-B3-SP						
	420969-16	322A-B3-KSP						
	420969-17	322A-R-B3-T, H322A-R-B3-T						
	420969-18	H322-R-B3-N-T, 322A-R-B3-K-T, H322A-R-B3-K-T						
	420969-19	H322A-R-B3-N-K-T, 322A-R-B5-T, H322A-R-B5-T						
	420969-20	H322A-R-B5-N-T, 322A-R-B5-K-T, H322A-R-B5-K-T H322A-R-B5-N-K-T						
		1-741488						

TCS/TCSA Dispenser Parts Manual
 Form 4576A Version 1.0
 Tokheim Corporation February 1996

SPEAKER & PRESETS ASSEMBLY

MODEL 411A & 422A (ONE PIECE DIAL)

TCS/TCOA Dispenser Parts Manual
 Form 4576A Version 1.0
 Tokheim Corporation February 1996

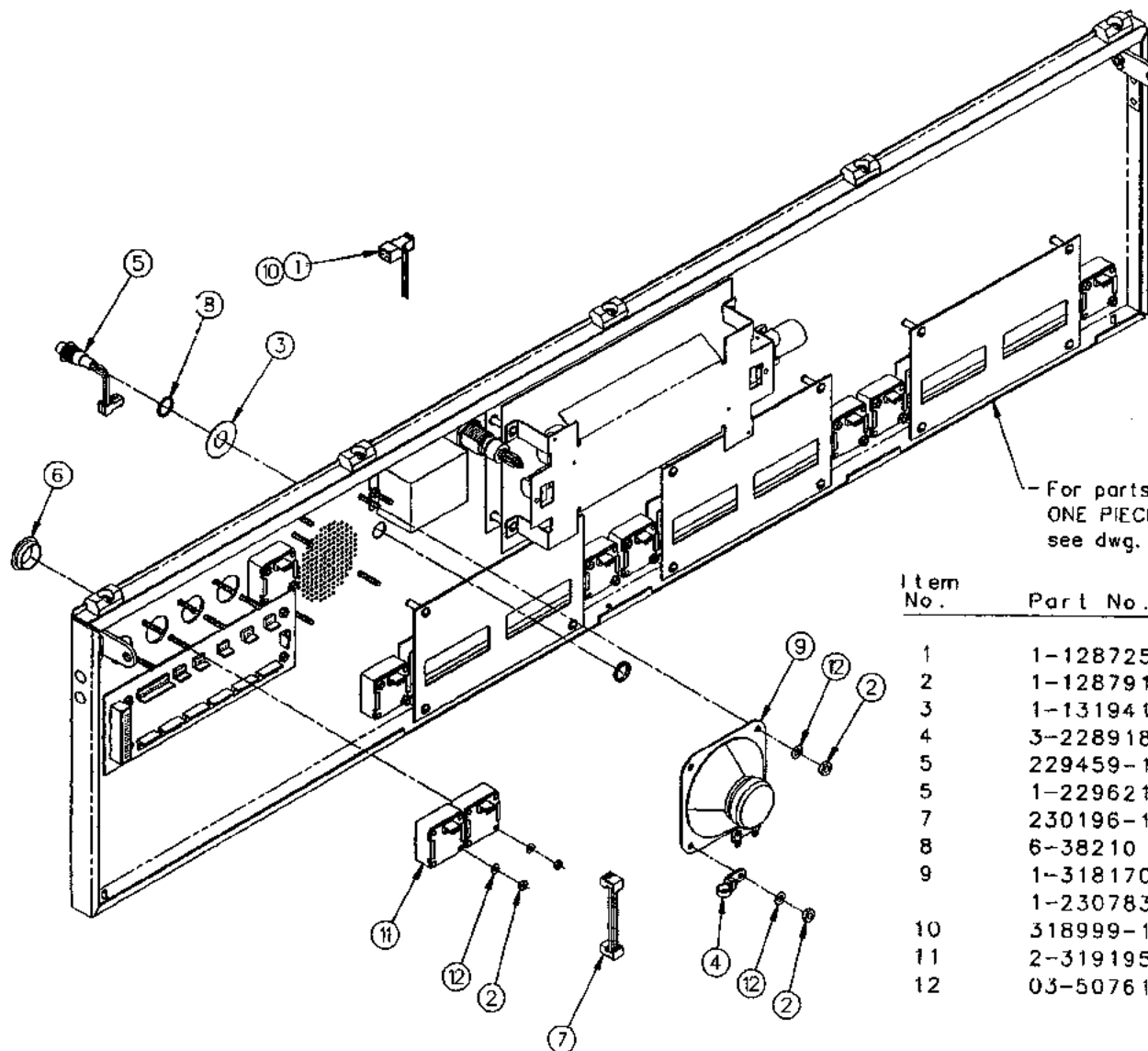

Item No.	Part No.	Name Of Part
1	1-128725	Cable Tie
2	1-128791	#6-32 Special Nut
3	1-131941	Assistance Plate
4	3-228918	Cable Clamp
5	229459-1	Push Button Switch Assy.
6	1-229621	Switch Grommet
7	230196-1	Wire Harness Assembly
8	6-38210	"O" Ring
9	1-318170	Speaker
	1-230783	Speaker Baffle
10	318999-1	Wire Harness Assembly
11	2-319195	Push Button Switch Assy.
12	03-50761	#6 Shakeproof Lockwasher

ONE PIECE DIAL ASSEMBLY (BACK LIT)
 (411A & 422A)

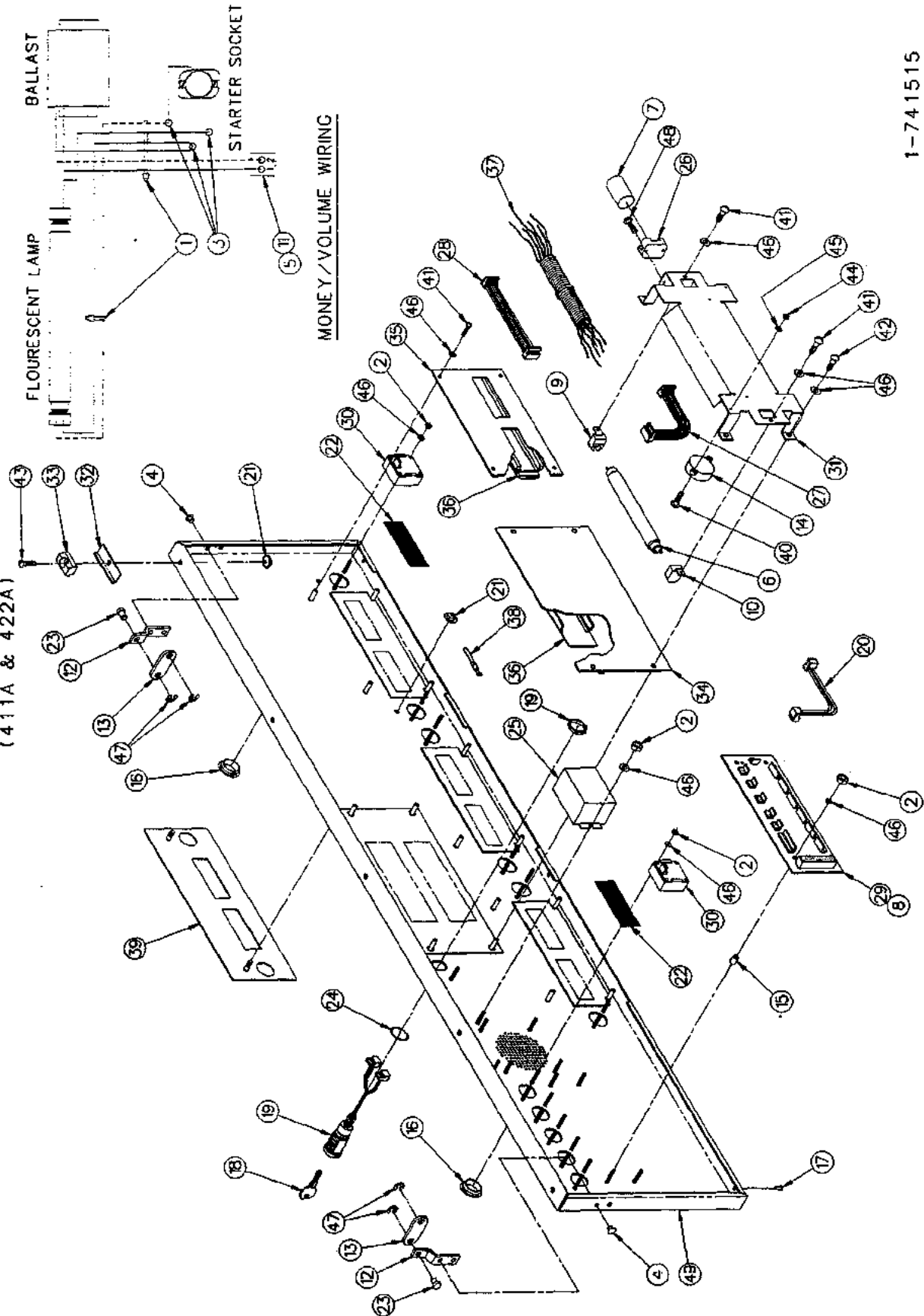

1-741515

ONE PIECE DIAL ASSEMBLY (BACK LIT)

(MODEL: 411A & 422A)

ITEM NO.	PART NO.	DESCRIPTION	ITEM NO.	PART NO.	DESCRIPTION	ITEM NO.	PART NO.	DESCRIPTION
1	1-128725	Cable Tie	26	1-315557	Starter Socket	39	<u>Panel Weld Assembly</u>	
2	1-128791	#6-32 Special Nut	27	<u>Wiring Harness Assembly (Money/Volume To PPU)</u>		420863-1	Cash/Credit	
3	1-129223	Wire Connector		317476-1	Side "A"	420863-2	Cash	
4	1-131006	Pop Rivet		317467-4	Side "B"	40	30-50001	#4-40 x 3/8" Long Round Head Machine Screw
5	2-131473	Socket	28	<u>Wiring Harness Assembly (PPU To PPU)</u>		41	90-50001	#6-32 x 5/16" Long Round Head Machine Screw
6	11-219435	Flourescent Lamp		317476-5	Side "B"	42	96-50001	#6-32 x 1/2" Long Round Head Machine Screw
7	1-226278	Starter		317476-6	Side "A"	43	256-50001	#10-24 x 3/4" Long Round Head Machine Screw
8	2-227359	Connector	29	317653-1	Dial Interconnect Board Assembly	44	02-50211	#4-40 Hex Nut
9	1-227766	Lamp Holder	30	2-319195	Push Button Switch Assembly	45	01-50761	#4 Shakeproof Lockwasher
10	3-227766	Lamp Holder	31	318974-1	Bracket & Standoff Assembly	46	03-50761	#6 Shakeproof Lockwasher
11	1-228606	Connector Housing	32	2-319013	Dial Rail	47	06-52482	Truarc Retaining Ring
12	1-228640	Bracket	33	1-319029	Dial Guide	48	20-55392	#4 x 3/8" Long Hex Washer Head Tapping Screw
13	1-228641	Link	34	<u>Money/Volume Board Assembly (Includes Item #36)</u>		49	<u>Dial & Plug Assembly</u>	
14	228677-1	Buzzer Assembly (Annunclator)		419091-3	Decimals		420769-16	411A & 422A
15	7-229606	Spacer	419091-4	Commas	420769-17	411A & 422A With Speaker		
16	1-229621	Switch Grommet	35	<u>Board Assembly (Includes Item #36)</u>		420769-18	411A & 422A With Speaker & Preset	
17	1-229652	Plastic Rivet		419202-5	Cash/Credit (Decimals)	420769-19	411A & 422A With DPT	
18	Key	Attendants (372I) Managers (592T)		419202-6	Cash (Decimals)	420769-20	411A & 422A With Speaker & DPT	
	2-229680			2-229680	419202-7	Cash/Credit (Commas)	420769-21	411A & 422A With Speaker, Preset & DPT
19	230187-1	Keylock Switch & Harness Assembly (Includes Item # 18)	36	2-419225	Liquid Crystal Display	For complete Dial Parts Assembly see drawing number: 420857. For complete Dial Accessories Assembly see drawing number: 420858.		
20	230196-1	Wire Harness Assembly	37	419763-9	Loom & Harness Assembly			
21	1-230432	#10-24 Capped Washer Locknut (With Seal)	38	420165-21	Lead Assembly			
22	1-230810	Light Filter						
23	1-231143	Pin						
24	7-38210	"O" Ring						
25	<u>Ballast</u>	110 Volt 220 Volt 50Hz 220 Volt 60Hz						
	1-315556							
	3-315556							
	4-315556							

TCS/TCSA Dispenser Parts Manual
Form 4576A Version 1.0
Tdkheim Corporation February 1996

WIRING SCHEMATIC FOR 30" 3 & 5 PRODUCT DIAL

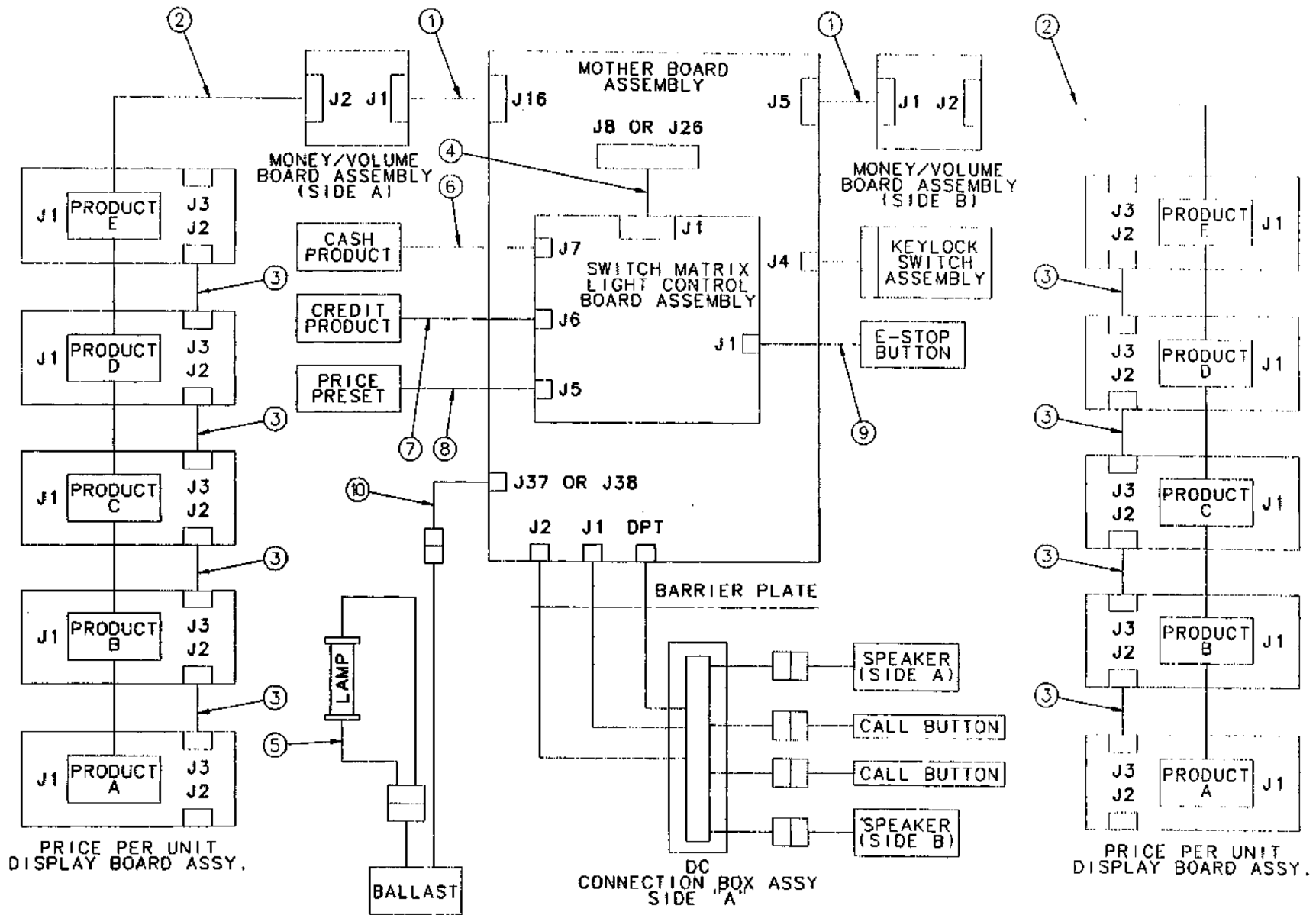

WIRING SCHEMATIC FOR 30" 3 & 5 PRODUCT DIAL

ITEM NO.	PART NO.	DESCRIPTION
1	2-229447	Display Ribbon Cable
2	<u>Ribbon Cable (Money/Volume J2 To Price Per Unit Display Unit J1)</u>	
	1-230893	5 Product Blender
	1-231139	3 Product Blender
3	230933-1	Price Per Unit Harness Assy.
4	1-230968	Switch Matrix Light Control Ribbon Cable
5	231017-1	Lamp Harness Assembly
6	<u>Cash Product Harness Assembly</u>	
	319081-1	5 Product Blender
	319081-3	3 Product Blender
7	<u>Credit Product Harness Assembly</u>	
	319081-1	5 Product Blender
	319081-3	3 Product Blender
8	319081-2	Price Preset Harness Assembly
9	319116-1	E-Stop Harness Assembly
10	319194-3	Wire Harness Assembly (Mother Board J37/J38 To Ballast)

1-741501

TCS/TCSA Dispenser Parts Manual
Form 4576A Version 1.0
Tokheim Corporation February 1996

SPEAKER & CALL BUTTON WIRING FOR TCS

Dial Assembly, Side "B"

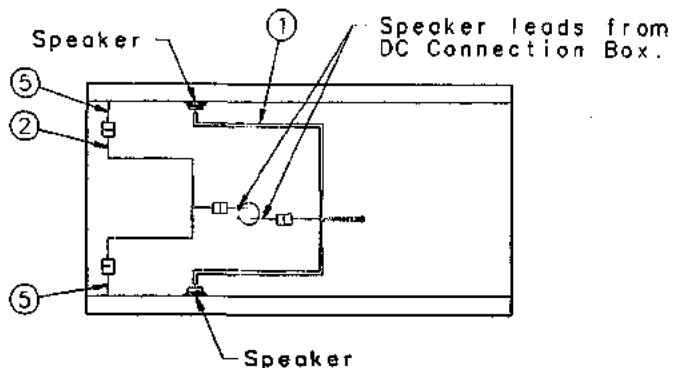

Dial Assembly, Side "A"

(MODEL TCS 30", 45" & 60")

Dial Assembly, Side "B"

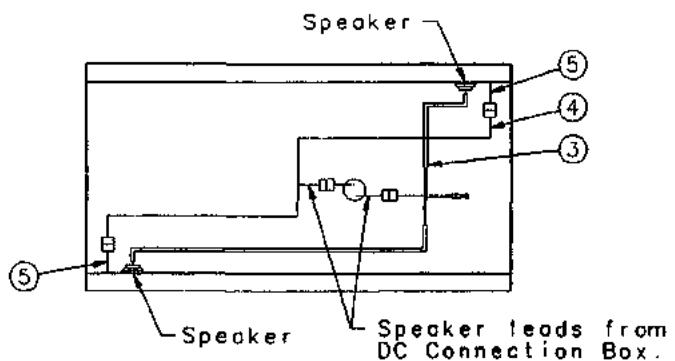

Dial Assembly, Side "A"

(MODEL TCS 30"A, 45"A & 60"A)

Item No.	Part No.	Name Of Part
1	228996-1	Speaker Wire Harness Assy. (30")
	228996-2	Speaker Wire Harness Assy. (45")
	228996-3	Speaker Wire Harness Assy. (60")
	229462-1	Speaker With Call Button Wire Harness Assembly (30")
	229462-2	Speaker With Call Button Wire Harness Assembly (45")
	229462-3	Speaker With Call Button Wire Harness Assembly (60")
2	229460-1	Call Button Wire Harness Assy. (311 & 312)
	229460-2	Call Button Wire Harness Assy. (413)
	229460-3	Call Button Wire Harness Assy. (614)
	229461-1	Call Button Wire Harness Assy. (30")
	229461-2	Call Button Wire Harness Assy. (45")
	229461-3	Call Button Wire Harness Assy. (60")
3	228996-4	Speaker Wire Harness Assy. (30")
	228996-5	Speaker Wire Harness Assy. (45"A)
	228996-6	Speaker Wire Harness Assy. (60"A)
	228996-7	Speaker Wire Harness Assy. (45"A Mobil)
	229462-4	Speaker With Call Button Wire Harness Assembly (30"A)
	229462-5	Speaker With Call Button Wire Harness Assembly (45"A)
4	229462-6	Speaker With Call Button Wire Harness Assembly (60"A)
	229460-5	Call Button Wire Harness Assy. (311A & 312A)
	229460-6	Call Button Wire Harness Assy. (614A & 628A)
	229461-4	Call Button Wire Harness Assy. (30"A)
	229461-5	Call Button Wire Harness Assy. (45"A)
	229461-6	Call Button Wire Harness Assy. (60"A)
5	229460-4	Call Button Ext. Wire Harness Assembly (322, 324, 322A & 324A)
	229460-5	Call Button Ext. Wire Harness Assy. (426 & 426A)
	229460-6	Call Button Ext. Wire Harness Assy. (628 & 628A)

ONE PIECE DIAL BLANK ASSEMBLY

(MODEL TCS "A")

For Steel Enclosure

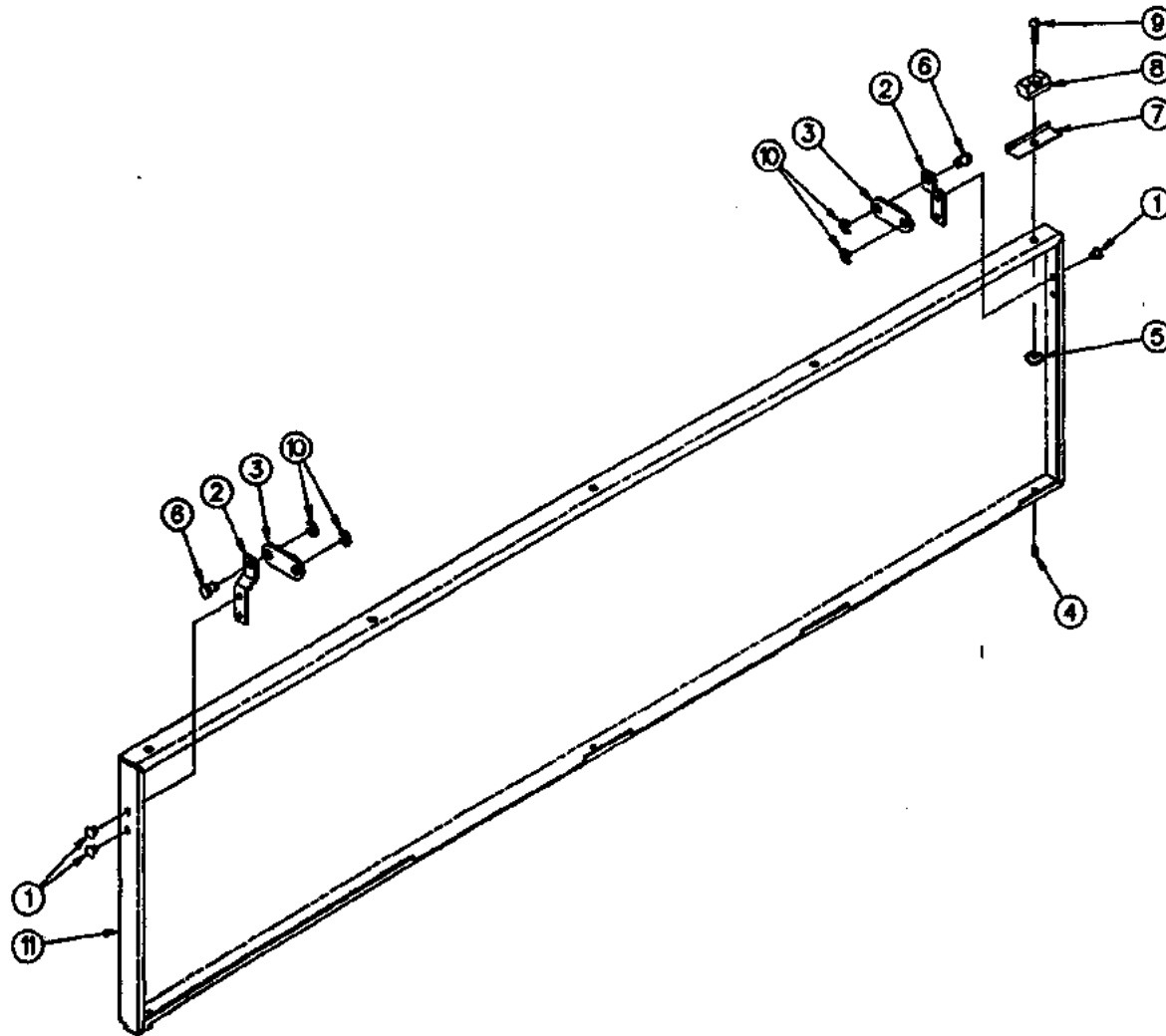

Item No.	Part No.	Name of Part
1	1-131006	Pop Rivet
2	1-228640	Bracket
3	1-228641	Link
4	1-229652	Plastic Rivet
5	1-230432	#10-24 Capped Washer Locknut (With Seal)
6	1-231143	Pin
7	<u>Dial Rail</u>	
	1-319013	60"
	2-319013	45"
	3-319013	30"
8	1-319029	Dial Guide
9	256-50001	#10-24 X 3/4 Long Round Head Machine Screw
10	06-52482	Truarc Retaining Ring
11	<u>Dial Blank</u>	
	3-418129	30"
	7-420427	45"
	7-420515	60"

For complete Dial Blank & Rail Assembly order:

420487-1	30"
420535-1	60"
420542-1	45"

1-741518

DIAL WIRING SCHEMATIC (TCS "A" MOBIL)

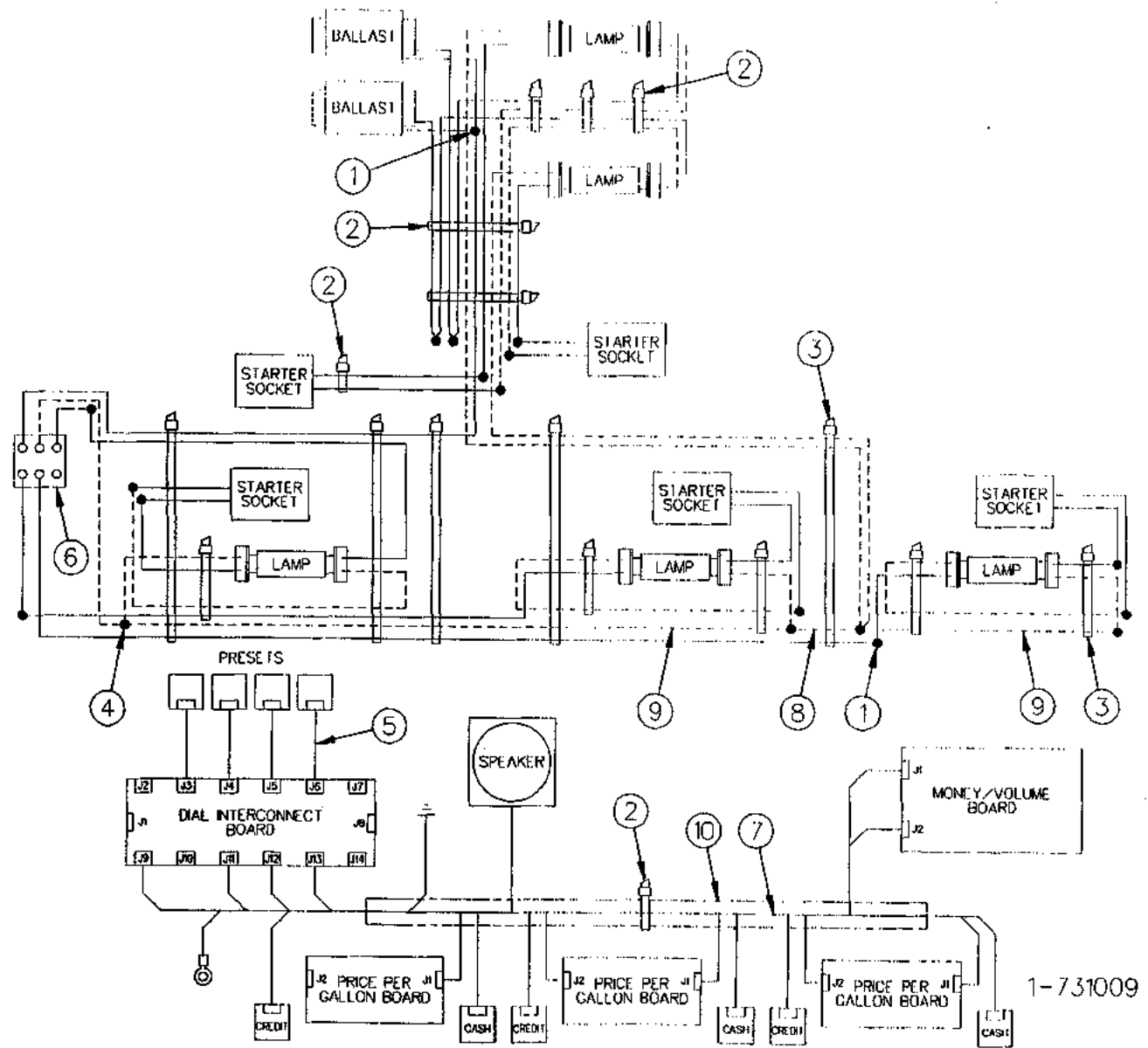

DIAL WIRING SCHEMATIC (TCS "A" MOBIL)

ITEM NO.	PART NO.	DESCRIPTION
1	1-127473	Wire Connector (#16 To #18 Wire)
2	1-128725	Cable Tie (3-7/8" to 4" Long)
3	2-128725	Cable Tie (5-1/2" to 6" Long)
4	1-129223	Wire Connector (#16 To #18 Wire)
5	230196-1	Presets Wiring Harness Assembly
6	318363-2	Lights Wiring Harness Assembly
7	<u>Signal Loom & Harness Assembly</u>	
	419763-3	M/MH426AR-KS/KSP (Front)
	419763-4	M/MH426AR-KS/KSP (Rear)
	419763-7	MH426AR-ST (Front)
	419763-8	MH426AR-ST (Rear)
8	007-548904-20	Conductor (#18 White)
9	015-548904-20	Conductor (#18 White)
10	008-552604	Flexible Loom

Reference: 419980 Dial Assembly

ONE PIECE DIAL ASSEMBLY (MONEY/VOLUME)

(TCS MOBIL)

ITEM NO.	PART NO.	DESCRIPTION	ITEM NO.	PART NO.	DESCRIPTION	ITEM NO.	PART NO.	DESCRIPTION
1	Hex Nut 1-128791 05-56211	#6-32 (High Hose) #10-24 (Low Hose)	18	230187-1	Keylock Switch Harness Assembly (Includes Item #17)	33	2-419225	Liquid Crystal Display
2	1-128791 2-228671	#6-32 Special Nut (High Hose) #10-24 Capped Washer Locknut (Low Hose)	19	1-230439	Capped Washer Locknut (With Seal)	34	3-419225	Liquid Crystal Display
3	1-131006	Pop Rivet	20	1-231143	Pin	35	<u>Screened Dial & Plug Assembly</u>	
4	1-131382	Pushnut Bolt Retainer (Low Hose Only)	21	1-231182	Money/Volume Window			M426A-R-K-S (Front)
5	<u>Spacer</u> 3-131460 7-229606	High Hose Low Hose	22	<u>Ballast</u> 1-315556 3-315556 4-315556	110 Volt 220 Volt 50 Hz 220 Volt 60 Hz			M426A-R-K-S (Rear)
6	11-219435	Fluorescent Lamp	23	1-315557	Starter Socket			M426A-R-K-S-P (Front)
7	1-226278	Starter	24	317653-1	Dial Interconnect Board Assembly			M426A-R-K-S-P (Rear)
8	2-227359	Connector (2 Pin Jumper)	25	<u>Price Per Gallon Light Bracket</u> 1-318151 2-318151	Low Hose High Hose			MH426A-R-S-T (Front)
9	1-227766	Lamp Holder	26	<u>Money/Volume Bracket</u> 1-318152 2-318152	Low Hose High Hose			MH426A-R-S-T (Rear)
10	3-227766	Lamp Holder	27	<u>Starter Socket Bracket</u> 1-318153 2-318153	Low Hose High Hose			MH426A-R-K-S (Front)
11	1-228540	Bracket	28	3-318940	"O" Ring			MH426A-R-K-S (Rear)
12	1-228541	Link	29	2-319013	Dial Rail			MH426A-K-S-P (Front) & MH426A-R-K-S-P (Front)
13	<u>Starter Socket Bracket</u> 1-228576 2-228576	Low Hose High Hose	30	1-319029	Dial Guide			MH426A-R-K-S-P (Rear) & MH426A-R-K-S-P (Rear)
14	228677-1	Buzzer Assembly (Annunciator)	31	418714-1	Price Per Gallon Board Assembly (Includes Item #33)			MH426A-R-S-T (Front)
15	<u>Price Per Gallon Window</u> 1-229515 1-231189	Low Hose High Hose	32	<u>Money/Volume Board Assembly (Includes Item #34)</u> 419091-1 419091-4	Commas Decimals			MH426A-R-S-T (Rear)
16	1-229552	Plastic Rivet				36	30-50001	#4-40 x 3/8" Long Round Head Machine Screw
17	<u>Key</u> 2-229680 3-229680	Attendants (372I) Managers (592T)				37	88-50001	#6-32 x 1/4" Long Round Head Machine Screw
						38	256-50001	#10-24 x 3/4" Long Round Head Machine Screw
						39	02-50211	#4-40 Hex Nut
						40	03-50761	#6 Shakeproof Lockwasher
						41	<u>Shakeproof Lockwasher</u> 03-50761 05-50761	#6 (High Hose) #10 (Low Hose)
						42	19-50761	#4 Shakeproof Lockwasher
						43	06-52482	Truarc Retaining Ring
								Reference: 419980 Dial Assembly

TCS/TCSA Dispenser Parts Manual
Form 4576A Version 1.0
Tokheim Corporation February 1996

CASH/CREDIT/PRESET & SPEAKER DIAL ASSEMBLY
(TCS MOBIL)

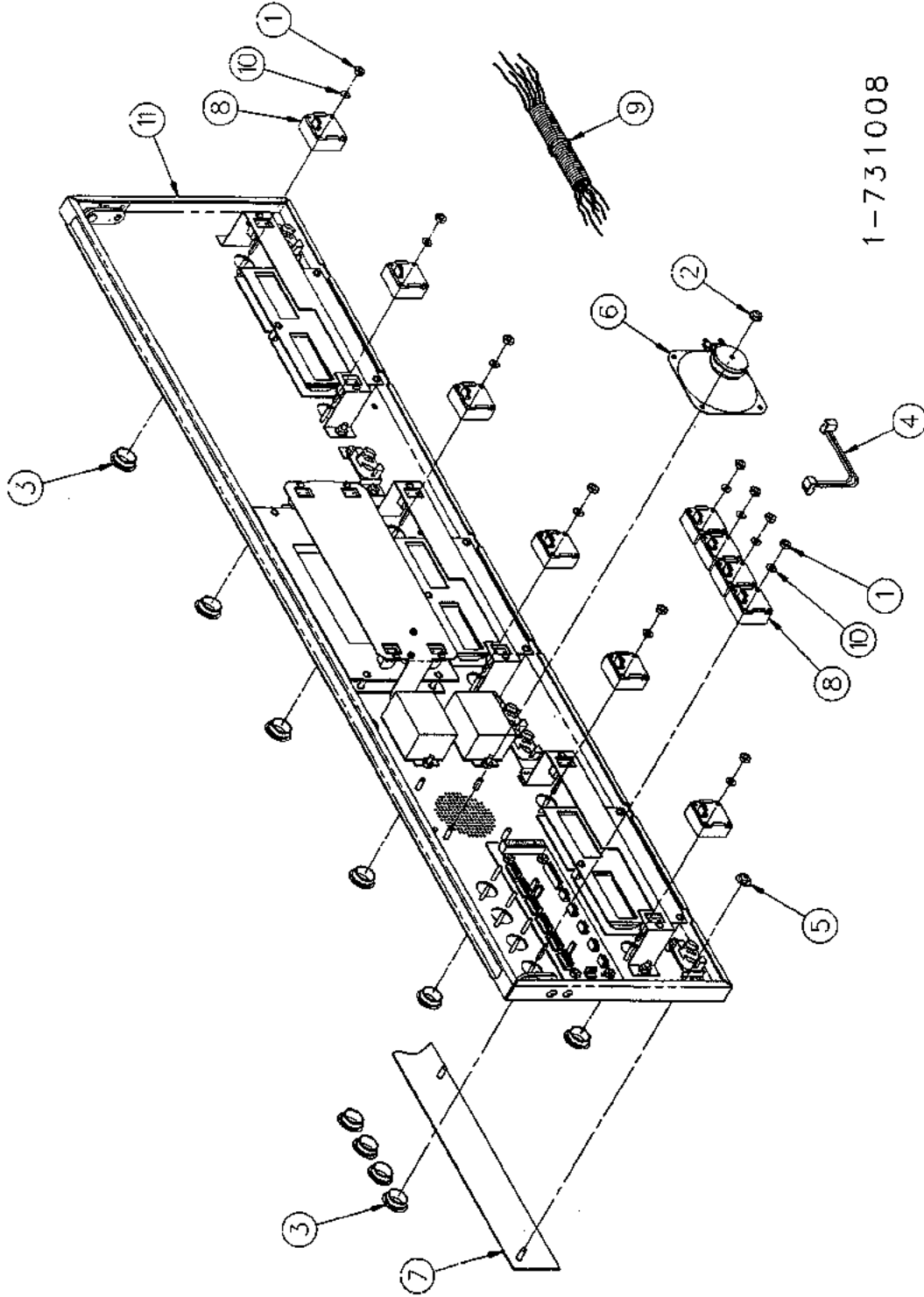

1-731008

CASH/CREDIT/PRESET DIAL ASSEMBLY (TCS MOBIL)

ITEM NO.	PART NO.	DESCRIPTION
1	1-128791	#6-32 Special Nut
2	2-228671	#10-24 Capped Washer Lockwasher
3	1-229621	Switch Grommet
4	230196-1	Preset Harness Assembly
5	1-230432	Capped Washer Lock Nut (With Seal)
6	1-318170	Speaker
7	318787-1	Product Panel Weld Assembly
8	3-319195	Push Button Switch
9		<u>Signal Loom & Harness Assembly</u>
	419763-3	M/MH426AR-KS/KSP (Front)
	419763-4	M/MH426AR-KS/KSP (Rear)
	419763-7	MH426AR-ST (Front)
	419763-8	MH426AR-ST (Rear)
10	03-50761	#6 Shakeproof Lockwasher
11	731007	<u>For parts callout of One Piece Dial Assembly see dwg. 731007</u>

Reference: 419980 Dial Assembly

TCS/TCSA Dispenser Parts Manual
Form 4576A Version 1.0
Tokheim Corporation February 1996

